

A herd of cattle is being driven down a dirt road in a rural, hilly landscape. The scene is captured from an elevated perspective, showing the road curving through the terrain. In the foreground, a person on a red ATV is driving towards the camera, while another person on a blue ATV is driving away from the camera. The herd of cattle is in the middle ground, moving down the road. The background shows rolling hills with some buildings and trees, including a prominent tree with yellow autumn foliage. The overall atmosphere is one of a busy day on a farm.

TRI-N CHAROLAIS FARMS
"Changing of the Guard"

DECEMBER 2, 2021

1:00 PM CDT - AT THE FARM - LENORE, MB

"37 Years In Red, White And Tan"

WELCOME FROM THE NYKOLIATION FAMILY

Friends, family, and fellow breeders this is your personal invitation to attend the "Changing of the Guard" Female Sale. After close to four decades of keeping a closed herd and selling very few females we are excited to open our herd up to you for the first time.

As many of you may have heard, this was to be a complete dispersal. However, Jesse's love for the industry and raising good Charolais cattle made him decide to continue under the TRI-N name. So, the question is... what do you do? Do you have a complete dispersal and announce the day of the sale that Jesse will be continuing in the industry and bidding against you on YOUR picks of the sale?

In typical TRI-N Fashion the answer is NO. Every animal in the sale is for sale. We appreciate your support and the time it takes to attend and bid at our sale.

After a lengthy discussion we decided to offer you our newest, most exciting genetics consisting of the ENTIRE bred heifer and two-year-old pens. We also handpicked select 3- to 8-year-old cows and heifer calves that we would build a herd around.

Through years of breeding, we have developed the largest red factor cow herd in Canada with the reddest bulls selling anywhere by public auction every year.

In my years of breeding cattle, I have always stuck to my basic principles. They are:

1) When starting a herd build a solid foundation. An old boy from South Dakota told me once to breed for quality females and the bulls will come later.

2) Udder quality. It doesn't have to be the biggest udder to bring you the biggest calf (butterfat).

3) Structure matters.

4) Consistency pays. I have never forgot my commercial background. Buyers want a consistent, even calf crop. You will notice our cow herd is very interrelated to give consistency.

Without any doubt, my biggest highlight over the years was breeding TRI-N Prairie Rose 401P. She was bred and developed based on the principles above. 401P is the reigning highest milk EPD female in the history of the Canadian Charolais Association 6 years in a row! We finally put her down after 17 years of service. Her udder was as sound as she was as a 2-year-old. Her daughter, 37S has been claimed by many as the most impressive red female in the industry. The Prairie Rose influence is heavy in the sale.

This sale truly is a changing of the guard sale. I plan to step back from the industry and allow Jesse to breed cattle with the knowledge I've passed onto him.

Joanne and I plan to spend more time with our grand kids and our friends throughout the world that we have made through the Charolais breed.

The Charolais breed is a people business and I hope to see my friends and fellow breeders in our holiday adventures.

In the words of my late brother Stan Nykolation "Thanks for coming."

Meru



Stan Nykolation



Meru, Joanne and Jesse Nykolation



Reflections of Tri-N Charolais

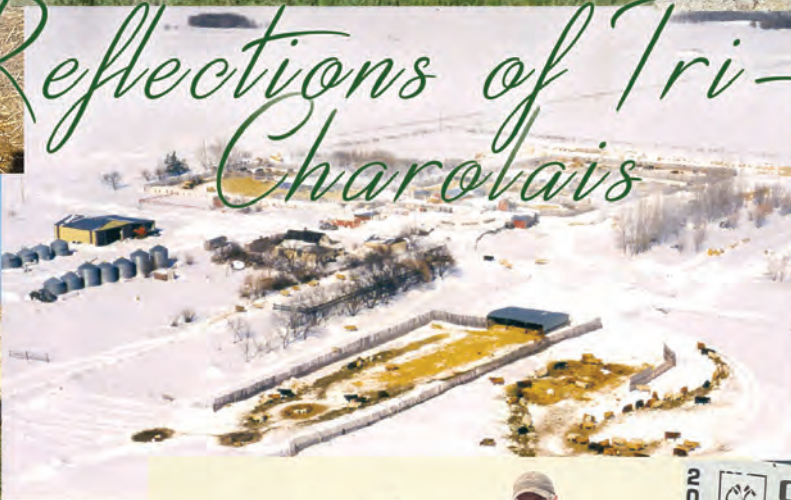

A HUMBLE BEGINNING

The Nykolation name is long standing and well known in livestock industry and the Charolais breed throughout Canada and beyond for close to 50 years. The families' humble beginnings started with Beaver Creek Charolais (Len, Marilyn, Gord and Micheal Nykolation and families) being the first in the 1970's. Shortly after, N7 Stock Farms (Gerald and Wendy Nykolation and families) was established.

The early days consisted of attending many female production sales with Merv's brothers Len and Gerald throughout Manitoba and Saskatchewan. On one November day back in 1983 they attended the Dennis Toms Charolais Dispersal at the Virden Auction Mart.

Miss DTM 18L, a 1979 born daughter of Mr. JN Cadet 83F entered the ring (consigned by Dennis Toms of Redvers, SK). When she left, TRI-N Charolais Farms was born! The third Nykolation in the purebred Charolais industry.

Today, well over 50% of the current TRI-N Charolais herd traces back to this first purchase. Cow families such as Prairie Rose, Creamsicle etc all trace back to Miss Dtm 18L. Beaver Creek Charolais were founding members of the West Man Breeders Group that were very active throughout the 70s, 80s and 90s. Through these sales Merv established his herd and later was an active consignor selling a few bulls and females in their annual bull and female sales held at the old Virden Auction Mart.

Performance testing played a large role from the beginning in the marketing of bulls for TRI-N. From the beginning bulls were entered in the Northwest (Roblin) Bull Test Station and the Manitoba (Douglas) Bull Test Station. Many top ten gaining bulls and banner bulls were consigned. In one year, TRI-N won both Roblin and Douglas Test Stations. The same was repeated with Douglas and Yellowhead.

Mervin was a founding member of the Yellowhead Bull Test Station in Neepawa and consigned every year until its ending in 2005. At this time, TRI-N consigned to the Cattlemans Classic Bull Multi-Breed Bull Sale in Virden with the other Charolais consignor Gord and Lisa Nykolation of Beaver Creek Charolais.

Merv remembers distinctly when the bull TRI-N Prefix 54Y was offered for sale in the 2012 Cattlemans Classic bull sale. Back in those days there was no facebook to promote your cattle, it was word of mouth and people face to face talking about it. When Prefix entered, the sales ring was jam packed, the alleys plugged and standing room only outside. Everyone was trying to get a look at the bull! Pretty dang exciting for little old Cattlemans Classic Virden, MB!

When the hammer finally fell Prefix went to Vikse Family Farm in Alberta and ended up being the highest priced Charolais bull in Canada that year. Interesting enough, a full sister to Prefix is the grandma of TRI-N Go North 2411H that sold this spring and ended up being the record high selling Charolais bull ever sold and bred in Manitoba history by public auction for \$80,000!

For ten years bulls were marketed through Cattlemans Classic. At this point Beaver Creek Charolais dispersed their cow herd.

In 2015, TRI-N Charolais created their own bull sale at Heartland Livestock in Virden. In 2018, the bull sale was moved to the farm at Lenore, MB where it remains today.



"Beaver Creek Charolais at their dispersal 2013."

Merv and Joanne Nykolation have two daughters (Tanis and Brittni) and two sons (Jesse and Curtis).

In 1995, the family moved to the main farm on NW-25-12-25W1 after taking it over from Merv's mother (Jennie) after the passing of his father where all 9 brother and sisters were raised.

The move went great and there were many family memories that were made. From the beginning, Tanis, Jesse and Brittni all took an active role in showing cattle in 4-H and the various Canadian Charolais Youth Association (CCYA) conferences throughout Canada.

Two CCYA projects included TRI-N Prairie Rose 401P (The beginning of the Prairie Rose cow family) and KCH Malibu 1M (the grandmother of TRI-N Malibu 72B). Both kids fell in love with the CCYA program, and the annual summer vacation was planned around the CCYA conference and shows location that year.

The kids are all grown up now. Tanis (Rob and grandkids Broolyn, Ashley and Hudson Boyd) reside on a grain farm in Rapid City, Curtis (grandson Damon) lives in Basswood and Brittni (Trevor and grandkids Hunter and Parker Morris) live in Melita.

Jesse (with support of his partner Delaney) is involved in the daily affairs of the family farm and are in the process of taking it over from Merv and Joanne. He has grown his cow herd by purchasing Merv's mature cow herd and plans to continue in the industry and hosting the annual bull sale for many years to come.

This sale represents the true "Changing of the Guard" from one generation to another. Close to half a century in the making by the Nykolation family.



FROM THE DESK AT T BAR C

Welcome to TRI-N Charolais Farms “Changing of the Guard” Female Sale, Thursday, December 2, 2021, at the farm, Lenore, Manitoba. After thirty-seven years in the Charolais breed, Merv Nykolation has decided to take it easy and hand the reins over to his son Jesse. They came to a decision that they would offer the entire group of bred yearlings and the entire two-year-old pasture and Jesse would purchase the cows three years and older to carry on the TRI-N tradition.

The TRI-N breeding program is amongst if not the largest red influence Charolais cow herd in North America. Much of the offering is an outcross to many programs and while building this high-performance program, they concentrated on selecting individuals with high milk and low birth weight traits. No doubt, SCX Jehu 233E, has caused a stir this spring and he will headline this event along with his progeny and service... what an opportunity to own this breed leader. The cow herd is sound, fertile, and packed full of longevity.

“Changing of the Guard” offers unlimited opportunities to select from an entire lineup of bred yearlings and two’s (some with heifer calves) out of proven, prolific cow families. As you read through this catalogue, you will see the success and influence that the TRI-N herd has had on the commercial industry and the many repeat customers, indicate that these cattle work! Whether you are looking for a donor cow for your front pasture or a group of sisters out of proven families, there is seedstock for all types of programs and all types of budgets, in white, tan or red. Whether you are looking for one or a trailer load, this event needs to be on your calendar.

For those who would like to preview the offering, plan to stop by the farm anytime prior the sale and Merv or Jesse will give you a tour. Don’t hesitate to give them a call to discuss the offering and which will fit your breeding intentions.

Plan to be a part of history and take advantage of 37 year of building and breeding the TRI-N program, whether it be with us in person, online or on the phone. During these times, feel free to give any of the T Bar C Team a call and we will be pleased to assist you in a professional and confidential manner with your selections.

Chris Poley



CHRIS POLEY
306-220-5006



SHANE MICHELSON
403-363-9973



BEN WRIGHT
519-374-3335

**CHANGING OF THE GUARD
DECEMBER 2, 2021
1:00 PM CDT
LENORE, MB**



SALE DAY INFORMATION

AUCTIONEER

CHRIS POLEY 306-220-5006

SALE STAFF

BEN WRIGHT 519-374-3335
 SHANE MICHELSON 403-363-9973
 LEVI RIMKE 204-851-4515

SALE MANAGEMENT

T BAR C CATTLE CO. LTD. 306-933-4200

MARKETING REPRESENTATIVES

JERRY MULLINS (USA) 763-302-9684
 ROD MCLEOD 403-540-7986
 TIM BULLICK 403-350-9858
 ANDREW REELEDER 403-848-1260

SALE DAY PHONES

BEN WRIGHT 519-374-3335
 SHANE MICHELSON 403-363-9973
 MERV NYKOLIATION 204-851-2290
 JESSE NYKOLIATION 204-851-3391

ONLINE BROADCASTING

DLMS
 MARK SHOLOGAN 403-363-9973



INSURANCE

KEYSTONE LIVESTOCK SERVICES
 LOIS MCRAE 204-573-5192

ACCOMODATIONS

JAY'S INN 204-748-2223
 COUNTRYSIDE INN 204-748-1244

LUNCH

JOIN US FOR SOME UKRANIAN HOSPITALITY AND NOON LUNCHEON

TRUCKING

KNILLS TRANSPORT (CANADA) 519-442-3106
 LATHROP TRUCKING (ENTIRE USA) 847-426-5009

TERMS

PLEASE VIEW THE TERMS ON THE INNER BACK COVER

Table of CONTENTS

THE JEHU FEATURE	PAGE 7
THE MALIBU FAMILY	PAGE 9
THE PRAIRIE ROSE FAMILY	PAGE 12
THE CREAMSICLE FAMILY	PAGE 24
THE BUFFY FAMILY	PAGE 30
THE MONTE PYTHON FAMILY	PAGE 34
THE REBA FAMILY	PAGE 38
THE MARLENE FAMILY	PAGE 43
THE RATIONALLE FAMILY	PAGE 49
THE SALLY FAMILY	PAGE 52
THE NICKHEATA FAMILY	PAGE 55
THE BARBRA ANNE FAMILY	PAGE 59
THE MISS MELANIE FAMILY	PAGE 62
THE TANZY FAMILY	PAGE 65
THE FRENCH MAID FAMILY	PAGE 67
SMALLER COW FAMILIES	PAGE 69
PROVEN BROOD MATRONS	PAGE 76
FUTURISTIC BRED YEARLINGS	PAGE 79
HERDBULL	PAGE 82
REFERENCE SIRES	PAGE 83
COW FAMILY INDEX	PAGE 86
TATTOO INDEX	PAGE 87

View the catalogue and videos online at
TRINCHAROLAIS.COM
AND BUYAGRO.COM

SALE DAY INFORMATION

HERD HEALTH

Birth to weaning: Inforce 3, Once PHM, IN, Vision 8 Somnus, Vista Once, Cocci treatment

Weaning: Vista Once, Vision 8 Somnus, Ivermectin and Deworming (oral)

Cow herd is on a full vaccination program for IBR, BVD, BRSV,P13, and Scours. All bred females selling have been vaccinated with Scour Boss. Herd bulls will be semen tested prior to the sale.

AMERICAN CUSTOMERS

Business as usual for trade. You can still attend our sale (Gov Canada requires proof of vaccination or a negative COVID test if you want to attend). For those who cannot, we also have a very capable sales staff, online bidding and Jerry Mullins (USA representative) in attendance. There have been no changes to the export of cattle. We will do all necessary health tests in a timely manner required for export. Animals will be delivered to the nearest point of entry at the seller's convenience. American Buyers will be charged an additional \$250/animal for the 1st animal and \$200/animal for each consecutive animal to cover health testing costs and delivery to the border. Exchange rates will be announced sale day at current bank rates. At the time of printing \$800 USD buys \$1000 Canadian. All animals are guaranteed exportable to the USA. If they don't pass their export tests, you don't own them!

JUNIOR INCENTIVE

Whether you live in Canada or the USA, we are proud to offer all Junior and 4-H/FFA members an additional 5% off the purchase of a heifer calf to use as their junior project. Papers must be transferred to the Junior member and will come off the purchase price at the time of settlement.

PROVINCES/STATES WE HAVE SOLD TO THE PAST 7 YEARS

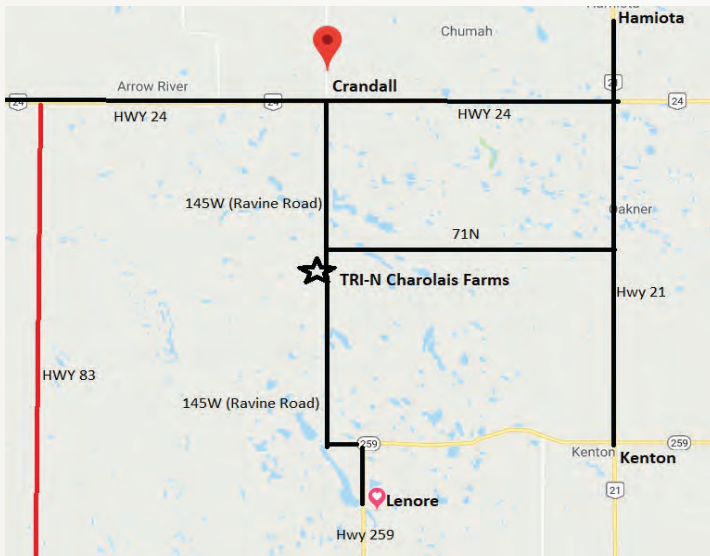

DIRECTIONS TO TRI-N CHAROLAIS

From Crandall- 6.5 miles S on Ravine Road
From Kenton- 6 miles N on HWY 21 to 71N. West (left) on 71N to 71N/145W. Turn south (left) half mile.
From Lenore- 2.5 miles N to speed curve, exit onto gravel and take 1st left (west), 1 mile west to 145W (Ravine Road). 3.5 miles North. Yard number 70097.
Watch for signs!

TRI-N CHAROLAIS
BOX 899, LENORE, MB
R0M 1E0

MERV & JOANNE NYKOLATION
P: 204-838-2107
C: 204-851-2290
trincharolais@gmail.com

JESSE NYKOLATION
P: 204-851-3391
jnykolation@yahoo.com



@nykolation



@Tri-N Charolais Farm



@Tri-N Charolais Farm



Lot **1**

SCX JEHU 233E

PMC757683 - SCX 233E - APRIL 24 2017 - HOMO POLLED

SCR TUFFY 0119
SCR TRIUMPH 2135
 SCR MS BABY DOLL 7140

SCX HILARIO 49T
SCX MISS MAGNUM 109X
 SCX MISS CHICO 48P

FC MARBLER 841 P
 SCR MISS KING MICKY 7055
 JCH MR BULL DOZER P146
 SCR MISS ROYALTY 9302
 SCX MAGNUM 27R
 SCX EMMA 107L
 SCR CHICO 1033L
 GOLD IN BOULDERS 411D

CE	BW	WW	YW	MILK	MTL
5.0	-0.7	64	130	20	52

- He sells along with 26 daughters
 - Service sire to 39 females

- Ranks in the top 1% of the breed for yearling weight, the top 2% for weaning weight, the top 3% for carcass weight, top 5% for total maternal; the top 10% for rib-eye and lean yield and the top 25% for birth weight

- In the winter of 2019, I remember getting a text from our good friends Darren and John Cook, Triple C Charolais of Steep Rock, MB. They told me they have a great bull this year and he was the best bull they have raised the past 50 years. His dam is one of their best cows and this bull is an absolute powerhouse. He had a full brother that was used in their herd and threw a very consistent set of calves.

- After seeing his sale picture, we were blown away. When we saw him in person he was even better! Even after dad and I brought our good friends Jack, Tyler, and Jared with us to the sale to critique the bull as we really value their eye for cattle. "Powerful, big barreled, smooth made, free moving... and look at that muzzle on that bull!" All comments not made by us but these astute cattlemen that day."

- We must agree with everyone on this one. SCX JEHU 233E is by far the stoutest, biggest barreled, massive white bull we have used on our ranch the last 37 years. He has calved so well and has thrown so much performance.

- Very rarely does a bull so proven and in his prime come for sale. 26 sons grossed \$303,600 to average \$11,680 at TRI-N and Triple C this year (with 11 sons selling to purebred herds from Quebec to Alberta, to Florida/Texas)! Enough said!!

- JEHU is an outcross to most popular pedigrees today including Firewater, Ledger, Outsider etc.

- As we see this bull age, we love him more and more. JEHU will have a lasting impact on our herd and the entire Charolais breed for years to come. We are excited to offer him to you!!

Selling 100% interest, full possession. TRI-N reserves the right to the use of in herd semen only.



SCX JEHU 233E as a two year old



Dam of JEHU at 10 years old

26 Sons Grossed \$303,600 To Average \$11,680... Enough Said!





Jesse Nykolation

KCH 1M

The MALIBU

Family

This family started with the purchase of Malibu 1M as a heifer calf from our good friends at KCH. When we saw her in the show ring as a heifer calf, I knew that female had ZING!! She came up for offer in the Hi-Weigh Breeders sale and we had to have her. Malibu 1M was a big barreled, long bodied, powerful female. She stamped her calves with that Malibu neck, long and smooth. Her track record was great producing 11 calves in 11 years and becoming a Gold Star Dam of Distinction.

This cow's genetics were the base of the high selling Charolais bull in Canada in 2012 (TRI-N Prefix 54Y) and the Manitoba record high seller TRI-N Go North 2411H.



Working at Vikse Farm (AB)



GO North 2411H - Working at Palmer (SK) and Bob (AB)



Lot **2**

TRI-N MALIBU 72B

PFC409171 - NMF 72B - MARCH 17 2014 - POLLED

HVA UPSTATE 8U
 MVY XPLOER 21X
 BAR EW TANYA 13T

SILVERSTREAM PERFORMER P38
 TRI-N MALIBU PLD ET 52Y
 KCH MALIBU 1M

WHITECAP JUSTICE 67R
 HVA PANSY 8P
 LAE PARAGON 404P
 BAR E W HW 86H
 EXCLUSIF
 SILVERSTREAM HOUGHTY H83E
 BALDRIDGE FASTTRACK 82F
 KCH DIXIE DARLIN PLD 1D

CE	BW	WW	YW	MILK	MTL
10.2	-2.9	50	80	29	54

- Ranks in the top 2% total maternal, 3% milk, 10% birth weight, 15% calving ease and 25% weaning weight
- The dam of TRI-N Go North 2411H, the \$80,000.00 highest priced Charolais bull ever bred or sold in Manitoba by public auction selected by Palmer Charolais and BOB Charolais, Stettler, Alberta
- The dam of TRI-N Hammer Time 5148E, herd bull for Wood River Charolais, McCord, Saskatchewan and TRI-N Triple XL 9430G selected by Jeff Smith
- Proven in the pasture and embryo program.
- Her maternal sister, TRI-N Malibu 2416H sells as lot 3
- **A.I. bred to SCX Jehu 233E on April 22, 2021 – due February 1, 2022 with no exposure**



Go North 2411H - son of lot 2



Hammertime 5148E - son of lot 2



2a

Lot 2a TRI-N MALIBU 2105J

PFC816875 - NYK 2105J - FEBRUARY 3 2021 - POLLED

SCR TRIUMPH 2135
SCX JEHU 233E
 SCX MISS MAGNUM 109X

SCR TUFFY 0119
 SCR MS BABY DOLL 7140
 SCX HILARIO 49T
 SCX MISS CHICO 48P

MVY XPLOERER 21X
TRI-N MALIBU 72B
 TRI-N MALIBU PLD ET 52Y

HVA UPSTATE 8U
 BAR EW TANYA 13T
 SILVERSTREAM PERFORMERP38
 KCH MALIBU 1M

BW	ADJ WW	CE	BW	WW	YW	MILK	MTL
85 lbs	768 lbs.	7.6	-1.8	57	105	25	53

- Ranks in the top 3% total maternal, 10% weaning and yearling weight, 15% for birth weight and the top 20% for milk
- Full sister to TRI-N Go North 2411H

Lot 3 TRI-N MALIBU 2416H

PFC795164 - NYK 2416H - FEBRUARY 13 2020 - POLLED

SCR TRIUMPH 2135
SCX JEHU 233E
 SCX MISS MAGNUM 109X

SCR TUFFY 0119
 SCR MS BABY DOLL 7140
 SCX HILARIO 49T
 SCX MISS CHICO 48P

SILVERSTREAM PERFORMERP38
TRI-N MALIBU PLD ET 52Y
 KCH MALIBU 1M

EXCLUSIF
 SILVERSTREAM HOUGHTY H83E
 BALDRIDGE FASTTRACK 82F
 KCH DIXIE DARLIN PLD 1D

CE	BW	WW	YW	MILK	MTL
5.4	0.0	56	111	27	55

- Ranks in the top 2% total maternal, 5% yearling weight, 10% milk and weaning weight, 15% carcass weight, 20% rib-eye and lean yield
- Her maternal sister, TRI-N Malibu 72B sells as lot 2
- A.I. bred to HVA Fireball 662F on April 14, 2021 – due January 24, 2022
- Exposed to K-Cow Gonzo 413G from May 5 to August 1, 2021
- Pregnancy examined favorable to the A.I. service

"We have purchased several bulls over the past years from the Tri-N Bull Sale for our purebred and commercial herd, all sight unseen. We are very satisfied with all of our purchases. The bulls are easy to handle, quiet and sound. Their calves are very vigorous at birth, and the cows calve with ease. Mervin and Jesse do a great job of getting them delivered, even when they have to travel halfway across the country. I would recommend these genetics and their great personalized service any day! Buying a bull here is easy."

Thanks, and keep up the great job guys!
 Mark and Tamy Frost, MRF Charolais, Kingsey Falls, Quebec



3



BY

NMF 401P
PICTURED AT 14 YEARS

The PRAIRIE ROSE Family

My biggest pride I've taken since I entered this business close to 4 decades ago was breeding this cow family and the great TRI-N Prairie Rose 401P. TRI-N Prairie Rose 401P is the highest milk EPD female in the Canadian Charolais Association registry 6 years in a row! She went on to be a Diamond Dam of Distinction. 401P also has two direct daughters (NMF 37S and 124T) and two granddaughters (NMF 91W and 945W). that have been awarded Gold Star Dams of Distinction. 91W is still in the herd and 37S, 124T and 945W) have been sent Texas A+M University this spring at 15, 14 and 12 respectively to highlight their embryo program.

This is the largest cow family in the offering and they all stem back to the first purebred female I purchased Miss DTM 18L. Pick a Prairie Rose, you won't regret it!



CANADA'S HIGHEST MILK EPD FEMALE



Donor dam of lots 4a-4d



Full Sibling to lots 4a-4d

- The donor dam TRI-N Prairie Rose 401P is the number 1 cow in the Canadian Charolais registry breed for milk. These embryo daughters are full sisters to the infamous TRI-N Prairie Rosebud 37S that some people refer to as the poster red factor Charolais female in the industry.
- 37S produced 13 calves here in the past 12 years and a Gold Star Dam of Distinction. At 15 years old she has been sent to Texas A+M University, College Station TX.
- When Jesse went to the Australian Charolais National Show in Dubbo, NSW in 2015, a picture of 37S was hanging on the wall.
What a humbling moment!

Lot 4a TRI-N PRAIRIE ROSE ET 37H

QPEFC795388 - NMF 37H - FEBRUARY 16 2020 - POLLED

CE	BW	WW	YW	MILK	MTL
9.0	0.4	44	77	36	58

SDC PROGRESS 16M
TRI-N PAYDAY 419P
STRI-N GRETA ASTROID 49G

GRANADAS RED ACE 17B
TRI-N PRAIRIE ROSE 401P
TRI-N MISS MONROE 244M

MSW Y2K
SCD MISS GYPSY 40J
MCCORR MONTE CARLO 24E
BORDER CORNER ASTRA 1X
WMG TANTARI 73Z
CHATEUA ALLISIA 217Z
TRI-N-SUPER JAMMER 7J
TRI-N CREAM OF THE CROP 27H



- Bred to Circle Cee Amplify 16H on April 21, 2021 – due January 31, 2022
- Exposed to Circle Cee Amplify 16H from April 30 to August 1, 2021
- Pregnancy examined favorable to the observed date

4a



Lot **4b** TRI-N PRAIRIE ROSE ET 74H

QPEFC795391 - NMF 74H - MARCH 3 2020 - POLLED

SDC PROGRESS 16M
TRI-N PAYDAY 419P
 STRI-N GRETA ASTROID 49G

GRANADAS RED ACE 17B
TRI-N PRAIRIE ROSE 401P
 TRI-N MISS MONROE 244M

MSW Y2K
 SCD MISS GYPSY 40J
 MCCORR MONTE CARLO 24E
 BORDER CORNER ASTRA 1X
 WMG TANTARI 73Z
 CHATEUA ALLISIA 217Z
 TRI-N-SUPER JAMMER 7J
 TRI-N CREAM OF THE CROP 27H

CE	BW	WW	YW	MILK	MTL
9.0	0.4	44	77	36	58

- A.I. bred to HVA Fireball 662F on April 20, 2021 – due January 30, 2022
 - Exposed to K-Cow Gonzo 413G from May 11 to August 1, 2021
 - Pregnancy examined favorable to the A.I. service



4c

Let 4c TRI-N PRAIRIE ROSE ET 76H

QPEFC795392 - NMF 76H - MARCH 7 2020 - POLLED

SDC PROGRESS 16M
TRI-N PAYDAY 419P
 STRI-N GRETA ASTROID 49G

GRANADAS RED ACE 17B
TRI-N PRAIRIE ROSE 401P
 TRI-N MISS MONROE 244M

MSW Y2K
 SCD MISS GYPSY 40J
 MCCORR MONTE CARLO 24E
 BORDER CORNER ASTRA 1X
 WMG TANTARI 73Z
 CHATEUA ALLISIA 217Z
 TRI-N-SUPER JAMMER 7J
 TRI-N CREAM OF THE CROP 27H

CE	BW	WW	YW	MILK	MTL
9.0	0.4	44	77	36	58

- Bred to Circle Cee Amplify 16H on April 21, 2021 – due January 31, 2022
- Exposed to Circle Cee Amplify 16H from May 12 to August 1, 2021
- Pregnancy examined favorable to the observed date

Let 4d TRI-N PRAIRIE ROSE ET 2425H

QPEFC795385 - NMF 2425H FEBRUARY 20 2020 - POLLED

SDC PROGRESS 16M
TRI-N PAYDAY 419P
 STRI-N GRETA ASTROID 49G

GRANADAS RED ACE 17B
TRI-N PRAIRIE ROSE 401P
 TRI-N MISS MONROE 244M

MSW Y2K
 SCD MISS GYPSY 40J
 MCCORR MONTE CARLO 24E
 BORDER CORNER ASTRA 1X
 WMG TANTARI 73Z
 CHATEUA ALLISIA 217Z
 TRI-N-SUPER JAMMER 7J
 TRI-N CREAM OF THE CROP 27H



4d

CE	BW	WW	YW	MILK	MTL
9.0	0.4	44	77	36	58

- Bred to Circle Cee Amplify 16H on April 11, 2021 – due January 21, 2022
- Exposed to Circle Cee Amplify 16H from May 2 to August 1, 2021
- Pregnancy examined favorable to the observed date



Lot 5 TRI-N PRAIRIE ROSE 43H

QPFC798041 - NMF 43H - FEBRUARY 16 2020 - POLLED

TRI-N CAPTAIN MORGAN 340A
TRI-N RED BARON 765E
 TRI-N MISS CHARHEAD 917W
 MVY XPLOER 21X
TRI-N PRAIRIE ROSE 402B
 TRI-N PRAIRIE ROSE 60Y

PRO-CHAR CPTN. MORGAN 8U
 TRI-N BUFFY 79T
 VAL-END APPRAISER 24J
 CHARHEAD MISS 23R
 HVA UPSTATE 8U
 BAR EW TANYA 13T
 TR RED SMOKE
 TRI-N-MISS MONROE 244M

CE	BW	WW	YW	MILK	MTL
13.8	-5.4	30	51	22	37

- Ranks in the top 1% for birth weight and 3% for calving ease
- **A.I. bred to HVA Fireball 662F on April 15, 2021 – due January 25, 2022**
- **Exposed to K-Cow Gonzo 413G from May 6 to August 1, 2021**
- **Pregnancy examined favorable to the A.I. service**

“We have purchased several red and tan bulls and females from the Nykoliations over the past 6 years. The bulls have put a lot of thickness and performance into our cattle and the females milk well. These bulls have sired great red and tan calves that sell great at the market every year. Thank you Merv and Jesse for allowing us to do this.”

Delwin and Char Walter, Walter's Charolais, Minot, ND

- Ranks in the top 10% for birth weight and calving ease
- Calved March 10, 2021
- Bull calf sired McTavish Icon 20G BW: 83 lbs.
- Adj-205 day wt: 741 lbs.
- Observed bred to Jack Foundation 7F on May 22, 2021
- Due March 1, 2022
- Exposed to Jack Foundation 7F from April 10 to August 2, 2021
- Pregnancy examined to the observed date



Lot 6 TRI-N PRAIRIE ROSE 1008G

QPFC771791 - NMF 1008G - MARCH 22 2019 - POLLED

WINN MANS MARQUEZ 821U
WINN MANS TERANTINO 9131Y
 WINN MANS SEDUCTIVE 9131W

WINN MANS LANZA 610S
 WINN MANS LA SENZA 435P
 SPARROWS CAJUN 485N
 WINN MAN SEDUCTIVE 052K

MVY XPLOER 21X
TRI-N PRAIRIE ROSE 402B
 TRI-N PRAIRIE ROSE 60Y

HVA UPSTATE 8U
 BAR EW TANYA 13T
 TR RED SMOKE
 TRI-N-MISS MONROE 244M

CE	BW	WW	YW	MILK	MTL
11.3	-2.5	41	66	21	42

Lot 7 TRI-N PRAIRIE ROSE 725E

PFC733389 - NMF 725E - FEBRUARY 11 2017 - POLLED

SPARROWS DURANGO 585P
WINN MANS LANZA 610S
 WINN MAN MERIT 036K

ABC LATORO 263G
 SPARROWS BLANCHE 585G
 MERIT 5133E
 MERIT SMOOTHIE 8073H

TRI-N-SUPER JAMMER 7J
TRI-N-MISS MONROE 244M
 TRI-N-CREAMOF THE CROP27H

4-L UNLIMITED YL13POLLED
 TRI-N-XLASSY POLLED 5X
 JBJ-TMB BLIZZARD 447D
 TRI-N-MONTE CARLO 901A

CE	BW	WW	YW	MILK	MTL
11.1	-1.8	33	75	34	51

- Ranks in the top 1% for milk, 10% for calving ease and total maternal and 15% for birth weight
- Maternal sister to the great TRI-N Prairie Rose 401P. The highest milk EPD female in the Canadian Charolais Association registry 6 years in a row.
- Her daughter, TRI-N Prairie Rose 916G, sells as lot 8
- Calved March 22, 2021
- Bull Calf sired by SCX Jehu 233E BW: 88 lbs. Adj-205 day wt: 862 lbs. Feature in 2022 bull sale.
- Observed bred to SCX Jehu 233E on May 10, 2021
- Due February 20, 2022
- Exposed to SCX Jehu 233E from April 10 to June 1, then exposed to TRI-N Red Baron 765E from June 2 to August 1, 2021
- Pregnancy examined to the observed date





10

Lot 8 TRI-N PRAIRIE ROSE 916G

PFC771616 - NMF 916G - FEBRUARY 10 2019 - POLLED

LT LEDGER 0332 P
CFC ALREADY PLATINUM 167D
 CFC WYOMING WIND 42N

WINN MANS LANZA 610S
TRI-N PRAIRIE ROSE 725E
 TRI-N-MISS MONROE 244M

LT BLUEGRASS 4017 P
 LT BRENDA 6120 PLD
 LT WYOMING WIND 4020 PLD
 CFC PERFECTION 1K
 SPARROWS DURANGO 585P
 WINN MAN MERIT 036K
 TRI-N-SUPER JAMMER 7J
 TRI-N-CREAMOFTHE CROP27H

CE	BW	WW	YW	MILK	MTL
13.3	-2.1	22	50	29	40

- Ranks in the top 3% for calving ease and milk, the top 15% for birth weight and the top 20% for marbling
- Her mother, TRI-N Prairie Rose 725E, sells as lot 7
- Calved January 25, 2021 heifer calf sired by McTavish Icon 20G BW: 88 lbs. died pneumonia
- A.I. bred to SCX Jehu 233E on April 17, 2021 – due January 27, 2022
- Exposed to SCX Jehu 2 236G from May 9 to August 2, 2021
- Pregnancy examined favorable to the A.I. date

Lot 9 TRI-N PRAIRIE ROSE 35H

QPFC798027 - NMF 35H - FEBRUARY 15 2020 - POLLED

HEJ CHESTER 1C
HEJ EINSTEIN 28E
 HEJ CATALINA SUNRISE 68C

PRO-CHAR CPTN. MORGAN 8U
TRI-N PRAIRIEROSEBUD 159Z
 TRI-N PRAIRIE ROSEBUD 945W

HEJ ARMAGEDDON 84A
 HEJ MURPHY 61A
 ANCHOR J JIMMY 15Y
 HEJ TEQUILA SUNRISE 76Y
 MOORE'S LARIAT 136L
 SDC MISS RACHEL 4J
 GRANADAS RED ACE 17B
 TRI-N-MISS MONROE 244M

CE	BW	WW	YW	MILK	MTL
11.1	-0.8	41	80	24	45

- Ranks in the top 10% for calving ease, 25% birth weight and milk
- Her twin sister 36H sells as lot 10
- Bred to Circle Cee Amplify 16H on May 24, 2021 – due March 4, 2022
- Exposed to Circle Cee Amplify 16H from April 30 to August 1, 2021
- Pregnancy examined favorable to the observed date

Lot 10 TRI-N PRAIRIE ROSE 36H

QPFC798029 - NMF 36H - FEBRUARY 15 2020 - POLLED

HEJ CHESTER 1C
HEJ EINSTEIN 28E
 HEJ CATALINA SUNRISE 68C

SDC LAREDO 17N
TRI-N PRAIRIE ROSE 124T
 TRI-N-PRAIRIE ROSE 401P

HEJ ARMAGEDDON 84A
 HEJ MURPHY 61A
 ANCHOR J JIMMY 15Y
 HEJ TEQUILA SUNRISE 76Y
 MOORE'S LARIAT 136L
 SDC MISS RACHEL 4J
 GRANADAS RED ACE 17B
 TRI-N-MISS MONROE 244M

CE	BW	WW	YW	MILK	MTL
11.1	-0.8	41	80	24	45

- Ranks in the top 10% for calving ease, 25% birth weight and milk
- Her twin sister 35H sells as lot 9
- Bred to Circle Cee Amplify 16H on June 1, 2021 – due March 11, 2022
- Exposed to Circle Cee Amplify 16H from April 20 to August 1, 2021
- Pregnancy examined to the observed date.



11

Lot 11 TRI-N PRAIRIE ROSE 581C

PFC414426 - NMF 581C - APRIL 8 2015 - POLLED

LAE WICHITA 911W
TWN YANGSTER 27Y
 TWN SABLE 33S

GRANADAS RED ACE 17B
TRI-N-PRAIRIE ROSE 401P
 TRI-N-MISS MONROE 244M

LT BLUEGRASS 4017 P
 LAE TANGO 707T
 ROCKLAND NOLAN 357N
 HOLMSYDE DREAM ALONG828H
 WMG TANTARI 73Z
 CHATEAU ALLISIA 217Z
 TRI-N-SUPER JAMMER 7J
 TRI-N-CREAMOFTHE CROP27H

CE	BW	WW	YW	MILK	MTL
11.3	-0.6	48	88	26	50

- Ranks in the top 10% for calving ease and total maternal and the top 15% for milk
- Maternal sister to the flush sisters lots 4A to 4D
- A son, TRI-N Omaha 65H, was selected by Curtis Longman, Kelvington, Saskatchewan
- Her mother, TRI-N Prairie Rose 401P, is a prolific producer and donor.
- 401P is the mother of TRI-N Payday ET 2436H selected by Bina Charolais, Lawton, North Dakota; TRI-N Explorer 412B, herd bull for K-Cow Ranch, Elk Point, Alberta; TRI-N Captain Morgan 368A selected by Tyrell Neidhardt, Hebron, North Dakota.
- Bred to SCX Jehu 233E on April 10, 2021 – due January 20, 2022
- Exposed to SCX Jehu 233E from April 10 to August 2, 2021
- Pregnancy examined to the observed date

Lot 11a TRI-N PRAIRIE ROSE 39J

QPFC816899 - NMF 39J - FEBRUARY 17 2021 - POLLED

PRO-CHAR YELLOW JACKET 6C
JACK FOUNDATION 7F
 BREMNERS BRITTANY 348Y

TWN YANGSTER 27Y
TRI-N PRAIRIE ROSE 581C
 TRI-N-PRAIRIE ROSE 401P

HRJ WIDOW MAKER 12A
 PRO-CHAR SALLY 8Y
 TRI-N DIGGER DAN 938W
 BREMNERS SWEETIE 667M
 LAE WICHITA 911W
 TWN SABLE 33S
 GRANADAS RED ACE 17B
 TRI-N-MISS MONROE 244M

ACT BW	ADJ WW	CE	BW	WW	YW	MILK	MTL
89 lbs	763 lbs	7.2	1.3	44	79	23	45



11a



13

Lot 12 TRI-N PRAIRIE ROSE 1019G

PFC771707 - NMF 1019G - MARCH 31 2019 - POLLED

TRI-N THRILLER PLD 173Z
SCX THRILLER 89B
 BWK BURST MARBLER 1149

TWN YANGSTER 27Y
TRI-N PRAIRIE ROSE 576C
 TRI-N-MISS MONROE 244M

TRI-N-SUPER JAMMER 7J
 TRI-N CREAMSICLE 85T
 FC MARBLER 864 P
 LJK MISS STARBURST 4006
 LAE WICHITA 911W
 TWN SABLE 33S
 TRI-N-SUPER JAMMER 7J
 TRI-N-CREAMOFTHE CROP27H

CE	BW	WW	YW	MILK	MTL
13.5	-5.2	62	104	27	58

- Ranks in the top 1% for total maternal; 2% for birth weight and weaning weight; 3% for calving ease; 10% for milk and 15% for yearling weight
- Her maternal sister, TRI-N Prairie Rose 55H, sells as lot 13
- Calved February 23, 2021 heifer calf sired by McTavish Icon 20G BW: 90 lbs. Adj-205 day wt: 785 lbs.
- Bred to SCX Jehu 2 236G on May 21, 2021 – due March 3, 2022
- Exposed to SCX Jehu 2 236G from April 10 to August 2, 2021
- Pregnancy examined to the observed date

Lot 13 TRI-N PRAIRIE ROSE 55H

QPFC798058 - NMF 55H - FEBRUARY 24 2020 - POLLED

TRI-N CAPTAIN MORGAN 340A
TRI-N RED BARON 765E
 TRI-N MISS CHARHEAD 917W

TWN YANGSTER 27Y
TRI-N PRAIRIE ROSE 576C
 TRI-N-MISS MONROE 244M

PRO-CHAR CPTN. MORGAN 8U
 TRI-N BUFFY 79T
 VAL-END APPRAISER 24J
 CHARHEAD MISS 23R
 LAE WICHITA 911W
 TWN SABLE 33S
 TRI-N-SUPER JAMMER 7J
 TRI-N-CREAMOFTHE CROP27H

CE	BW	WW	YW	MILK	MTL
14.8	-5.6	52	85	19	45

- Ranks in the top 1% for birth weight; 2% calving ease and 15% weaning weight
- Her maternal sister, TRI-N Prairie Rose 1019G, sells as lot 12
- A.I. bred to HVA Fireball 662F on April 18, 2021 – due January 28, 2022
- Exposed to K-Cow Gonzo 413G from May 9 to August 1, 2021
- Pregnancy examined favorable to the A.I. service



12



15

Lot 15 TRI-N PRAIRIE ROSE 109H

QPFC798422 - NMF 109H - MARCH 29 2020 - POLLED

TRI-N CAPTAIN MORGAN 340A
TRI-N RED BARON 765E
 TRI-N MISS CHARHEAD 917W

TWN WHISTLER 44W
TRI-N PRAIRIE ROSE 394A
 TRI-N PRAIRIE ROSE 102Y

PRO-CHAR CPTN. MORGAN 8U
 TRI-N BUFFY 79T
 VAL-END APPRAISER 24J
 CHARHEAD MISS 23R
 PLEASANT DAWN VOLCANO 3T
 KCH REDNECK GIRL 57R
 TRI-N-PAYDAY 419P
 TRI-N PRARIE ROSE 124T



NMF 394A - dam of lot 15

CE	BW	WW	YW	MILK	MTL
8.7	-1.4	48	82	22	46

- Ranks in the top 20% for birth weight and 25% for calving ease
- Bred to Circle Cee Amplify 16H on April 14, 2021 – due January 24, 2022
- Exposed to Circle Cee Amplify 16H from May 5 to August 1, 2021
- Pregnancy examined favorable to the observed date

Lot 14 TRI-N PRAIRIE ROSE 73H

QPFC798056 - NMF 73H - MARCH 3 2020 - POLLED

SCR TRIUMPH 2135
SCX JEHU 233E
 SCX MISS MAGNUM 109X

PRO-CHAR CPTN. MORGAN 8U
TRI-N PRAIRIE ROSE 183Z
 TRI-N-PRAIRIE ROSE 401P

SCR TUFFY 0119
 SCR MS BABY DOLL 7140
 SCX HILARIO 49T
 SCX MISS CHICO 48P
 HARVIE REDEMPTION 36P
 EFH DAISY MAE 30J
 GRANADAS RED ACE 17B
 TRI-N-MISS MONROE 244M

CE	BW	WW	YW	MILK	MTL
7.8	-1.4	53	99	23	49

- Ranks in the top 15% weaning weight and total maternal and 20% for birth weight and yearling weight
- Her mother has produced sons selected by BG Stock Farm, Redvers and Joseph Stewart, Yorkton, Saskatchewan
- Bred to Circle Cee Amplify 16H on June 27, 2021 – due April 7, 2022
- Exposed to Circle Cee Amplify 16H from April 20 to August 1, 2021
- Pregnancy examined favorable to the observed date



18

Lot 16 TRI-N PRAIRIE ROSEBUD 824F

PFC750479 - NMF 824F - FEBRUARY 12 2018 - POLLED

TRI-N THRILLER PLD 173Z
SCX THRILLER 89B
 BWK BURST MARBLER 1149

PRO-CHAR CPTN. MORGAN 8U
TRI-N PRAIRIEROSEBUD 207Z
 TRI-N-PRAIRIE ROSEBUD37S

TRI-N-SUPER JAMMER 7J
 TRI-N CREAMSICLE 85T
 FC MARBLER 864 P
 LJK MISS STARBURST 4006
 HARVIE REDEMPTION 36P
 EFH DAISY MAE 30J
 TRI-N-PAYDAY 419P
 TRI-N-PRAIRIE ROSE 401P

CE	BW	WW	YW	MILK	MTL
10.8	-2.7	54	94	26	53

- Ranks in the top 3% for total maternal, 10% for calving ease and birth weight, the top 15% for weaning weight and milk
- Calved January 28, 2021 heifer sired by SCX Jehu 233E BW: 90 lbs. died twisted stomach
- **Observed bred to SCX Jehu 233E on April 22, 2021 – due February 1, 2022**
- **Exposed to SCX Jehu 233E from April 10 to August 2, 2021**
- **Pregnancy examined to the observed date**

Lot 17 TRI-N PRAIRIE ROSEBUD 732E

QPFC733404 - NMF 732E - FEBRUARY 13 2017 - POLLED

SPARROWS KINGSTON 139Y
HRJ BULLETPROOF 411B
 HRJ MISS PARIS 7S

SOS CRIMSON TIDE 97S
TRI-N PRAIRIE ROSEBUD 945W
 TRI-N-PRAIRIE ROSEBUD37S

WINN MANS LANZA 610S
 SPARROWS DELIGHT 374P
 HRJ MR RED TAZ 23P
 HRJ MISS PARIS 40P
 MGM MERLOT
 P-3 LADY PERFECT 6-146F
 TRI-N-PAYDAY 419P
 TRI-N-PRAIRIE ROSE 401P

CE	BW	WW	YW	MILK	MTL
9.3	-1.6	34	68	25	42

- Ranks in the top 15% for birth weight and milk, 20% for calving ease and 25% for fat
- Her daughter, TRI-N Prairie Rosebud 60H sells as lot 18
- Produced TRI-N Little Texas 905G selected by Luke Smith, Sundre, Alberta
- Her maternal sister, TRI-N Prairie Rose Bud 49H, sells as lot 19
- Calved January 26, 2021 heifer calf by HEJ Einstein 28E BW: 92 lbs. died pneumonia
- **Observed bred to SCX Jehu 233E on April 18, 2021 – due January 28, 2022**
- **Exposed to SCX Jehu 233E from April 10 to August 2, 2021**
- **Pregnancy examined to the observed date**

Lot 18 TRI-N PRAIRIE ROSEBUD 60H

QPFC798064 - NMF 60H - FEBRUARY 26 2020 - POLLED

TRI-N CAPTAIN MORGAN 340A
TRI-N RED BARON 765E
 TRI-N MISS CHARHEAD 917W

HRJ BULLETPROOF 411B
TRI-N PRAIRIE ROSEBUD 732E
 TRI-N PRAIRIE ROSEBUD 945W

PRO-CHAR CPTN. MORGAN 8U
 TRI-N BUFFY 79T
 VAL-END APPRAISER 24J
 CHARHEAD MISS 23R
 SPARROWS KINGSTON 139Y
 HRJ MISS PARIS 7S
 SOS CRIMSON TIDE 97S
 TRI-N-PRAIRIE ROSEBUD37S

CE	BW	WW	YW	MILK	MTL
11.3	-3.6	40	73	19	39

- Ranks in the top 5% for birth weight and 10% for calving ease
- Her mother, TRI-N Prairie Rosebud 732E sells as lot 17
- **Observed bred to Circle Cee Amplify 16H on June 22, 2021 – due April 1, 2022**
- **Exposed to Circle Cee Amplify 16H from April 10 to August 1, 2021**
- **Pregnancy examined to the observed date**

Lot 19 TRI-N PRAIRIE ROSEBUD 49H

PFC798049 - NMF 49H - FEBRUARY 19 2020 - POLLED

SCR TRIUMPH 2135
SCX JEHU 233E
 SCX MISS MAGNUM 109X

SOS CRIMSON TIDE 97S
TRI-N PRAIRIE ROSEBUD 945W
 TRI-N-PRAIRIE ROSEBUD37S

SCR TUFFY 0119
 SCR MS BABY DOLL 7140
 SCX HILARIO 49T
 SCX MISS CHICO 48P

MGM MERLOT
 P-3 LADY PERFECT 6-146F
 TRI-N-PAYDAY 419P
 TRI-N-PRAIRIE ROSE 401P

CE	BW	WW	YW	MILK	MTL
8.5	-0.9	43	92	25	47

- Ranks in the top 15% for milk and 25% for calving ease, birth weight and total maternal
- Her maternal sister, TRI-N Prairie Rosebud 732E sells as lot 17
- Her mother, TRI-N Prairie Rosebud 945W was a terrific bull producer – sons have been selected by W5 Farms, Darcy Watson, David Ives, Donald Lewis and TRI-N Icon 693D, herd bull for Amabec Charolais, Warkworth, Ontario
- **A.I. bred to HVA Fireball 662F on April 10, 2021 – due January 20, 2022**
- **Exposed to K-Cow Gonzo 413G from May 1 to August 1, 2021**
- **Pregnancy examined favorable to the A.I. service**



19

Lot 20 TRI-N PRAIRIE ROSEBUD 37G

QPFC772956 - NMF 37G - APRIL 24 2019 - POLLED

HEJ CHESTER 1C
HEJ EINSTEIN 28E
 HEJ CATALINA SUNRISE 68C

TRI-N-PAYDAY 419P
TRI-N-PRAIRIE ROSEBUD 37S
 TRI-N-PRAIRIE ROSE 401P

HEJ ARMAGEDDON 84A
 HEJ MURPHY 61A
 ANCHOR J JIMMY 15Y
 HEJ TEQUILA SUNRISE 76Y

SDC PROGRESS 16M
 TRI-N-GREAT ASTROID 49G
 GRANADAS RED ACE 17B
 TRI-N-MISS MONROE 244M

CE	BW	WW	YW	MILK	MTL
9.4	0.3	37	71	26	44

- Ranks in the top 15% for milk and 20% for calving ease
- Her mother is a full sister to lots 4A-D the infamous TRI-N Prairie Rosebud 37S. She has numerous top females in our herd and raised herd sires for Wells Charolais (OK USA), Cleveland Charolais (SD USA) and Nielson Bros Charolais (MO USA).
- 37S produced 13 calves here in the past 12 years and a Gold Star Dam of Distinction. At 15 years old she is now working at Texas A+M University, College Station TX.
- **Observed bred to SCX Jehu 233E on April 18, 2021 – due February 28, 2022**
- **Exposed to SCX Jehu 233E from April 10 to August 2, 2021**
- **Pregnancy examined to the observed date**



20

Lot 21 TRI-N PRAIRIE ROSEBUD 1027G

QPFC773023 - NMF 1027G - APRIL 08 2019 - POLLED

LT LEDGER 0332 P
CFC ALREADY PLATINUM 167D
 CFC WYOMING WIND 42N

TRI-N CAPTAIN MORGAN 340A
TRI-N PRAIRIE ROSEBUD 769E
 TRI-N-PRAIRIE ROSEBUD37S

LT BLUEGRASS 4017 P
 LT BRENDA 6120 PLD
 LT WYOMING WIND 4020 PLD
 CFC PERFECTION 1K

PRO-CHAR CPTN. MORGAN 8U
 TRI-N BUFFY 79T
 TRI-N-PAYDAY 419P
 TRI-N-PRAIRIE ROSE 401P

CE	BW	WW	YW	MILK	MTL
12.8	-2.2	38	65	22	41

- Ranks in the top 4% for calving ease and the top 15% for birth weight
- Calved March 9, 2021 bull calf sired by B&L Dark Horse 27G
- BW: 89 lbs. Adj-205 day wt: 909 lbs.
- **Observed bred to TRI-N Red Baron 765E on April 18, 2021 – due January 28, 2022**
- **Exposed to TRI-N Red Baron 765E from April 10 to August 2, 2021**
- **Pregnancy examined to the observed date**

Lot 20a TRI-N PRAIRIE ROSEBUD 133J

APPLIED FOR - NMF 133J - APRIL 9 2021 - POLLED

SOS HOOEY PLD 127D
MCTAVISH ICON 20G
 MCTAVISH FAYE 93E

WINN MANS CHAVEZ 826Y
 FFBB ABBI 307A
 WINN MANS CUERVO 4A
 MCTAVISH FAYE 37X

HEJ CHESTER 1C
 HEJ CATALINA SUNRISE 68C
 TRI-N-PAYDAY 419P
 TRI-N-PRAIRIE ROSE 401P

ACT BW	ADJ WW	CE	BW	WW	YW	MILK	MTL
78 lbs	876 lbs	7.9	0.7	38	76	20	39



21



The CREAMSICLE Family

Very closely related to the Prairie Rose cow family and I consider these females as part of it. Both trace back to TRI-N Cream of the Crop 27H (Jesse's first 4-H heifer), a gold star dam who produced until 14. This cow family was named after TRI-N Creamsicle 85T which produced TRI-N Thriller 176Z which was the sire of SCX Thriller 89B that sired some of the nicest females in the offering. A whole life's work to breed this cow family.



Working at Triple C Charolais



Working at TRI-N Charolais

- Ranks in the top 15% for marbling and the top 20% for weaning and yearling weight
- Her daughter, TRI-N Prairie Rose 67H, sells as lot 23
- Her mother, TRI-N Creamsicle 324A, a red foundation cow with sons selected by Riddell Farms, Pierson, Manitoba; Frank & Pattie Woroneski and Willowside Ranch Ltd., Neepawa, Manitoba
- Calved February 10, 2021
- Bull calf sired by Jack's Foundation 7F BW: 89 lbs. Adj-205 day wt: 729 lbs.
- Bred to Jack Foundation 7F on April 10, 2021 – due January 20, 2022
- Exposed to Jack Foundation 7F from April 10 to August 2, 2021
- Pregnancy examined to the observed date



22

Lot **22** TRI-N CREAMSICLE 850F

QPFC750500 - NMF 850F - FEBRUARY 19 2018 - POLLED

MERIT ROUNDUP 9508W	MXS VERMILLION 527R
TRI-N ROCKEFELLER PLD 607D	MERIT YOLANDA 7244T
TRI-N NICKHEATA 950W	SOS CRIMSON TIDE 97S
	TRI-N NICKHEATA 98T
	HARVIE REDEMPTION 36PU
PRO-CHAR CPTN. MORGAN 8U	EFH DAISY MAE 30J
TRI-N CREAMSICLE 324A	TRI-N-PAYDAY 419P
TRI-N CREAMSICLE 85T	TRI-N-CREAMSICLE 2R

CE	BW	WW	YW	MILK	MTL
4.2	1.8	52	98	18	44

Lot **23** TRI-N PRAIRIE ROSE 67H

QPFC795925 - NMF 67H - FEBRUARY 28 2020 - POLLED

TRI-N CAPTAIN MORGAN 340A	PRO-CHAR CPTN. MORGAN 8U
TRI-N RED BARON 765E	TRI-N BUFFY 79T
TRI-N MISS CHARHEAD 917W	VAL-END APPRAISER 24J
	CHARHEAD MISS 23R
	MERIT ROUNDUP 9508W
TRI-N ROCKEFELLER PLD 607D	TRI-N NICKHEATA 950W
TRI-N CREAMSICLE 850F	PRO-CHAR CPTN. MORGAN 8U
TRI-N CREAMSICLE 324A	TRI-N CREAMSICLE 85T

CE	BW	WW	YW	MILK	MTL
8.8	-1.4	55	96	14	42

- Ranks in the top 10% for weaning, 15% marbling, 20% calving ease and birth weight and 25% for yearling weight
- Her mother, TRI-N Creamsicle 850F, sells as lot 22
- Bred to Circle Cee Amplify 16H on April 8, 2021
- Due January 18, 2022
- Exposed to Circle Cee Amplify 16H from April 29 to August 1, 2021
- Pregnancy examined favorable to the observed date



23



Lot 24 TRI-N CREAMSICLE 972G

PFC771697 - NMF 972G - FEBRUARY 26 2019 - POLLED

TRI-N THRILLER PLD 173Z
SCX THRILLER 89B
 BWK BURST MARBLER 1149

MVY XPLOER 21X
TRI-N CREAMSICLE 431B
 TRI-N CREAMSICLE 97Y

TRI-N-SUPER JAMMER 7J
 TRI-N CREAMSICLE 85T
 FC MARBLER 864 P
 LJK MISS STARBURST 4006
 HVA UPSTATE 8U
 BAR EW TANYA 13T
 BEAVER CREEK HARD-CORE299
 TRI-N CREAMSICLE 85T

CE	BW	WW	YW	MILK	MTL
6.9	0.5	57	96	24	52

- Ranks in the top 5% for total maternal, 10% for weaning weight and 25% for yearling weight
- Her maternal sister, TRI-N Prairie Rose 64H, sells as lot 25
- Calved February 12, 2021 Bull Calf sired by McTavish Icon 20G BW: 87 lbs. Adj-205 day wt: 700 lbs.
- **A.I. bred to SCX Jehu 233E on May 18, 2021 – due February 28, 2022**
- **Exposed to SCX Jehu 2 2236G from June 1 to August 2, 2021**
- **Pregnancy examined favorable to the A.I. date**

We purchased a dark red Captain Morgan son for our ranch in South Texas for our herd of Brahman cows (sight unseen). We are very impressed with the bull. He slicked off and adapted well to our warm climate. The calves are really impressive and are extremely uniform and beefy. Jesse and Merv know their cattle well and was a pleasure to deal with. Great folks-great cattle. I'd highly recommend their red Charolais bulls on your Brahman cows!!

Philip, Nora, James and Stella Drake, P-N Cattle and Hay LLC, Edinburg, TX



Lot **25** **TRI-N PRAIRIE ROSE 64H**

PFC798067 - NMF 64H - FEBRUARY 27 2020 - POLLED

SCR TRIUMPH 2135
SCX JEHU 233E
 SCX MISS MAGNUM 109X

MVY XPLOER 21X
TRI-N CREAMSICLE 431B
 TRI-N CREAMSICLE 97Y

SCR TUFFY 0119
 SCR MS BABY DOLL 7140
 SCX HILARIO 49T
 SCX MISS CHICO 48P
 HVA UPSTATE 8U
 BAR EW TANYA 13T
 BEAVER CREEK HARD-CORE299
 TRI-N CREAMSICLE 85T

CE	BW	WW	YW	MILK	MTL
8.4	-1.7	50	92	21	46

- Ranks in the top 15% for birth weight and 25% weaning weight
- Her maternal sister, TRI-N Creamsicle 972G, sells as lot 24
- **A.I. bred to HVA Fireball 662F on April 10, 2021 – due January 20, 2022**
- **Exposed to K-Cow Gonzo 413G from May 1 to August 1, 2021**
- **Pregnancy examined favorable to the A.I. service**



- Her maternal brother, TRI-N Elvis 61H, was selected by Noah Weleski, Lancaster, Minnesota
- Calved March 4, 2021
- Heifer calf sired McTavish Icon 20G BW: 70 lbs. Adj-205 day wt: 742 lbs.
- A.I. bred to SCX Jehu 233E on May 10, 2021 – due February 20, 2022
- Exposed to SCX Jehu 2 236G from June 1 to August 2, 2021
- Pregnancy examined to the A.I. date

Lot 26 TRI-N CREAMSICLE 989G

QPFC771769 - NMF 989G - MARCH 4 2019 - POLLED

<p>WINN MANS MARQUEZ 821U WINN MANS TERANTINO 9131Y WINN MANS SEDUCTIVE 9131W</p> <p>TRI-N CRACKER JACK 370U TRI-N CREAMSICLE 1018X TRI-N CREAMSICLE 85T</p>	<p>WINN MANS LANZA 610S WINN MANS LA SENZA 435P SPARROWS CAJUN 485N WINN MAN SEDUCTIVE 052K VAL-END APPRAISER 24J TRI-N-PRAIRIE ROSEBUD37S TRI-N-PAYDAY 419P TRI-N-CREAMSICLE 2R</p>
--	---

CE	BW	WW	YW	MILK	MTL
6.4	1.3	48	78	18	42

Lot 27 TRI-N CREAMSICLE 9448G

QPFC771623 - NMF 9448G - APRIL 24 2019 - POLLED

<p>LT LEDGER 0332 P CFC ALREADY PLATINUM 167D CFC WYOMING WIND 42N</p> <p>TRI-N CAPTAIN MORGAN 340A TRI-N CREAMSICLE 806E TRI-N CREAMSICLE 85T</p>	<p>LT BLUEGRASS 4017 P LT BRENDA 6120 PLD LT WYOMING WIND 4020 PLD CFC PERFECTION 1K PRO-CHAR CPTN. MORGAN 8U TRI-N BUFFY 79T TRI-N-PAYDAY 419P TRI-N-CREAMSICLE 2R</p>
--	--

CE	BW	WW	YW	MILK	MTL
12.8	-2.7	40	71	20	41



- Ranks in the top 4% for calving ease, 10% for birth weight and the top 15% for marbling
- Bred to SCX Jehu 233E on May 21, 2021 – due March 3, 2022
- Exposed to SCX Jehu 233E from April 10 to August 2, 2021
- Pregnancy examined to the observed date



27a

Lot 27a TRI-N CREAMSICLE 2143J

APPLIED FOR - NMF 2143J - FEBRUARY 26 2021 - POLLED

SOS HOOEY PLD 127D
MCTAVISH ICON 20G
 FFBB ABBI 307A

CFC ALREADY PLATINUM 167D
TRI-N CREAMSICLE 9448G
 TRI-N CREAMSICLE 806E

WINN MANS CHAVEZ 826Y
 FFBB ABBI 307A
 WINN MANS CUERVO 4A
 MCTAVISH FAYE 37X

LT LEDGER 0332 P
 CFC WYOMING WIND 42N
 TRI-N CAPTAIN MORGAN 340A
 TRI-N CREAMSICLE 85T

ACT BW	ADJ WW	CE	BW	WW	YW	MILK	MTL
84 lbs	847 lbs	9.6	-0.8	40	75	17	37

Lot 28 TRI-N PRAIRIE ROSE 68H

PFC798070 - NMF 68H - MARCH 01 2020 - POLLED

SCR TRIUMPH 2135
SCX JEHU 233E
 SCX MISS MAGNUM 109X

BEAVER CREEK HARD-CORE299
TRI-N CREAMSICLE 97Y
 TRI-N CREAMSICLE 85T

SCR TUFFY 0119
 SCR MS BABY DOLL 7140
 SCX HILARIO 49T
 SCX MISS CHICO 48P

DIM CREEK REVENUE 430R
 BEAVER CREEK MISS 233S
 TRI-N-PAYDAY 419P
 TRI-N-CREAMSICLE 2R

CE	BW	WW	YW	MILK	MTL
3.8	1.8	53	102	20	46

- Ranks in the top 15% for weaning and yearling weight and the top 20% for carcass weight
- A.I. bred to HVA Fireball 662F on April 11, 2021 – due January 21, 2022
- Exposed to K-Cow Gonzo 413G from May 2 to August 1, 2021
- Pregnancy examined favorable to the A.I. service

Lot 29 TRI-N PRAIRIE ROSE 51H

PFC798053 - NMF 51H - FEBRUARY 21 2020 - POLLED

SCR TRIUMPH 2135
SCX JEHU 233E
 SCX MISS MAGNUM 109X

MVY XPLOER 21X
TRI-N CREAMSICLE 657D
 TRI-N CREAMSICLE 85T

SCR TUFFY 0119
 SCR MS BABY DOLL 7140
 SCX HILARIO 49T
 SCX MISS CHICO 48P

HVA UPSTATE 8U
 BAR EW TANYA 13T
 TRI-N-PAYDAY 419P
 TRI-N-CREAMSICLE 2R

CE	BW	WW	YW	MILK	MTL
6.2	-0.5	51	96	23	49

- Ranks in the top 15% for total maternal, the top 20% for weaning weight and the top 25% for yearling weight
- Bred to K-Cow Gonzo 43G on July 10, 2021 – due April 20, 2022
- Exposed to K-Cow Gonzo 413G from April 20 to August 1, 2021
- Pregnancy examined favourable to the observed date



NMF 180Z

noisibol/ym stesl

The **B U F F Y** Family

The cow family is responsible for TRI-N Captain Morgan 340A that you will find in virtually all our red pedigrees. It started with TRI-N Buffy 79T who is still producing today and is running with the big herd of cows at 14. Every bull that cow has had, has made the bull sale and sold. Several are working in purebred herds such as Wilgenbush Charolais (SK), Nielson Bros (MO), Doll Charolais (ND) and TRI-N. Her son last year was our lead off dark red bull selling to DUCHSHERER Grain and Livestock (ND). This cow family will put punch in your genetics with unparalleled capacity.



Working at TRI-N and Doll Charolais (ND)



Working at Wilgenbush Charolais (SK)



Lot **30**

TRI-N BUFFY 180Z

QPFC396153 - NMF 180Z - MARCH 11 2012 - POLLED

HARVIE REDEMPTION 36P
PRO-CHAR CPTN. MORGAN 8U
 EFH DAISY MAE 30J

TRI-N-PAYDAY 419P
TRI-N BUFFY 79T
 TRI-N BUFFY 6R

LT WYOMING WIND 4020 PLD
 HARVIE MS MOLSON 53M
 GXR MR CARLO 2E
 EFH MISS DAISY MAE 17D
 SDC PROGRESS 16M
 TRI-N-GREAT ASTROID 49G
 SDC LAREDO 17N
 TRI-N-ROUND -UP 3K

CE	BW	WW	YW	MILK	MTL
5.8	-0.8	54	93	18	45

- Ranks in the top 15% for weaning weight and marbling and the top 25% for birth weight
- Full sister to TRI-N Captain Morgan 340A, a foundation sire here that needs no introduction.
- Sons have been selected by Hilltop View Farms, Mortlach, Saskatchewan; Tom Cunningham, South Bruce Peninsula, Ontario; Darin G. & Jackie Becker, Roblin; Darcy Watson, Rossendale, Manitoba; Terri Cockle Broadview, Saskatchewan and RT Farms, Westlock Alberta.
- Proven donor cow averaging over 15 embryos the four times she was flushed
- Dam (79T) has proven track record in pasture and embryo production and still producing at 14 years old
- Calved January 30, 2021 Bull calf sired by SCX Jehu 233E BW: 90 lbs. died of twisted bowel
- **A.I. bred to SCX Jehu 233E on April 17, 2021 – due January 27, 2022**
- **Exposed to SCX Jehu 233E from April 10 to August 2, 2021**
- **Pregnancy examined to the A.I. date**



30a

Lot 30a TRI-N BUFFY ET 2403H

QPEFC795144 NMF 2403H JANUARY 27 2020 - POLLED

SPARROWS KINGSTON 139Y
HRJ BULLETPROOF 411B
 HRJ MISS PARIS 7S

PRO-CHAR CPTN. MORGAN 8U
TRI-N BUFFY 180Z
 TRI-N BUFFY 79T

WINN MANS LANZA 610S
 SPARROWS DELIGHT 374P
 HRJ MR RED TAZ 23P
 HRJ MISS PARIS 40P
 HARVIE REDEMPTION 36P
 EFH DAISY MAE 30J
 TRI-N-PAYDAY 419P
 TRI-N BUFFY 6R

CE	BW	WW	YW	MILK	MTL
9.0	0.4	44	77	36	58

- Full brothers sold in 2021 bull sale to RT Farms Weststock AB and Terri Cockle Broadview SK.
- Bred to Circle Cee Amplify 16H on April 21, 2021 – due January 31, 2022
- Exposed to Circle Cee Amplify 16H from May 12 to August 1, 2021
- Pregnancy examined favorable to the observed date

Lot 30c TRI-N BUFFY 180Z X PLEASANT DAWN CHISUM 216A

THREE (3) EMBRYOS

EATONS BIG BUD 10402 P
PLEASANT DAWN CHISUM 216A
 PLEASANT DAWN MAGGIE 316X

PRO-CHAR CPTN. MORGAN 8U
TRI-N BUFFY 180Z
 TRI-N BUFFY 79T

EATONS TREASURE 8076
 MISS GRAND HOUSE 360
 PLEASANT DAWN MAGNUM 56T
 PLEASANT DAWN RIO 216P
 HARVIE REDEMPTION 36P
 EFH DAISY MAE 30J
 TRI-N-PAYDAY 419P
 TRI-N BUFFY 6R

PE CE	PE BW	PE WW	PE YW	PE MILK	PE MTL
6.6	-1.0	57.5	108.5	21	50

Lot 30b TRI-N BUFFY 180Z X HRJ BULLETPROOF 411B

THREE (3) EMBRYOS

SPARROWS KINGSTON 139Y
HRJ BULLETPROOF 411B
 HRJ MISS PARIS 7S

PRO-CHAR CPTN. MORGAN 8U
TRI-N BUFFY 180Z
 TRI-N BUFFY 79T

WINN MANS LANZA 610S
 SPARROWS DELIGHT 374P
 HRJ MR RED TAZ 23P
 HRJ MISS PARIS 40P
 HARVIE REDEMPTION 36P
 EFH DAISY MAE 30J
 TRI-N-PAYDAY 419P
 TRI-N BUFFY 6R

PE CE	PE BW	PE WW	PE YW	PE MILK	PE MTL
0.9	3.05	51	91	20	45.5

All embryos are Canadian Qualified. For USA customers recipient cows are available and can be shipped pregnant in calf. Embryos stored at Ranchland Vet Services, Carnduff SK.

Lot 30d TRI-N BUFFY 180Z X SVY WIZARD 707E

THREE (3) EMBRYOS

HRJ CROWD FAVOURITE 515C
SVY WIZARD 707E
 SVY STARSTRUCK 409B

PRO-CHAR CPTN. MORGAN 8U
TRI-N BUFFY 180Z
 TRI-N BUFFY 79T

SPARROWS KINGSTON 139Y
 HRJ MISS PARIS 7S
 TR PZC MR TURTON 0794 ET
 SVY STARSTRUCK 8X
 HARVIE REDEMPTION 36P
 EFH DAISY MAE 30J
 TRI-N-PAYDAY 419P
 TRI-N BUFFY 6R

PE CE	PE BW	PE WW	PE YW	PE MILK	PE MTL
5.0	0.35	43.5	76.5	20.5	42.5



32

Lot 31 TRI-N BUFFY 1002G

QPFC772943 - NMF 1002G - MARCH 20 2019 - POLLED

TRI-N CAPTAIN MORGAN 340A
TRI-N RED BARON 765E
 TRI-N MISS CHARHEAD 917W

SOS CRIMSON TIDE 97S
TRI-N BUFFY 63Y
 TRI-N BUFFY II 51S

PRO-CHAR CPTN. MORGAN 8U
 TRI-N BUFFY 79T
 VAL-END APPRAISER 24J
 CHARHEAD MISS 23R
 MGM MERLOT
 P-3 LADY PERFECT 6-146F
 SDC LAREDO 17N
 TRI-N-ROUND -UP 3K

CE	BW	WW	YW	MILK	MTL
11.7	-3.4	50	95	19	44

- Ranks in the top 5% for birth weight, 10% for calving ease and marbling and the top 25% for weaning and yearling weight
- Her maternal sister, TRI-N Buffy 46H, sells as lot 32
- Her mother, TRI-N Buffy 63Y, is the dam of TRI-N Dillinger 623D selected by Walters Charolais, Minot, ND and TRI-N Bounty Hunter 507C selected by Bina Charolais and Effertz Key Ranch, Velva, ND
- **Bred to Jack Foundation 7F on April 15, 2021 – due January 25, 2022**
- **Exposed to Jack Foundation 7F from April 10 to August 2, 2021**
- **Pregnancy examined to the observed date**

Lot 32 TRI-N BUFFY 46H

QPFC798045 - NMF 46H - FEBRUARY 18 2020 - POLLED

HEJ CHESTER 1C
HEJ EINSTEIN 28E
 HEJ CATALINA SUNRISE 68C

SOS CRIMSON TIDE 97S
TRI-N BUFFY 63Y
 TRI-N BUFFY II 51S

HEJ ARMAGEDDON 84A
 HEJ MURPHY 61A
 ANCHOR J JIMMY 15Y
 HEJ TEQUILA SUNRISE 76Y
 MGM MERLOT
 P-3 LADY PERFECT 6-146F
 SDC LAREDO 17N
 TRI-N-ROUND -UP 3K

CE	BW	WW	YW	MILK	MTL
8.7	-0.3	36	83	22	40

- Ranks in the top 15% for marbling and the top 25% for calving ease
- Maternal sister, TRI-N Buffy 1002G sells as lot 31
- **Bred to Circle Cee Amplify 16H on April 28, 2021 – due February 9, 2022**
- **Exposed to Circle Cee Amplify 16H from May 19 to August 1, 2021**
- **Pregnancy examined favorable to the observed date**



31



NME 1056X

The MONTE PYTHON Family

Very similarly related to the Reba Cow family that produced TRI-N Payday 419P that you will find in virtually all our pedigrees for a reason. Both cow families trace back to Border Corner Astra 1X, a 1988 model (the year Jesse was born) descendant of the Artiste French breeding. These females all have that full deep flank that's so hard to find in today's cattle. You will pick them out!



- Ranks in the top 4% for total maternal, 10% for milk, 20% for weaning weight and 25% for marbling
- Her daughter, TRI-N Monte Python 988G, sells as lot 34
- A son, TRI-N Creed 854F, was selected by Doug Kerr, Ninette, Manitoba
- **Bred to Jack Foundation 7F on April 12, 2021 – due January 22, 2022**
- **Exposed to Jack Foundation 7F from April 10 to August 2, 2021**
- **Pregnancy examined to the observed date**



33

Lot 33 TRI-N MONTE PYTHON 678D

QPFC708925 - NMF 678D - MARCH 15 2016 - POLLED

FFBB RED BUCKLE PLD 16X
BEAVER CREEK COUNTRY 261A
 BEAVER CREEK GINGER 271W

PRO-CHAR CPTN. MORGAN 8U
TRI-N MONTE PYTHON 906B
 TRI-N MONTE PYTHON 1056X

JWX SILVER BUCKLE 524U
 FFBB NAREN ANN PLD 836U
 DIM CREEK REVENUE 430R
 BEAVER CREEK KALEI 251K
 HARVIE REDEMPTION 36P
 EFH DAISY MAE 30J
 TRI-N-PAYDAY 419P
 TRI-N-MONTE PYTHON 48G

CE	BW	WW	YW	MILK	MTL
2.6	0.9	51	94	27	52

Lot 33a TRI-N MONTE PYTHON 10J

QPFC816893 - NMF 10J - FEBRUARY 9 2021 - POLLED

PRO-CHAR YELLOW JACKET 6C
JACK FOUNDATION 7F
 BREMNERS BRITTANY 348Y

BEAVER CREEK COUNTRY 261A
TRI-N MONTE PYTHON 678D
 TRI-N MONTE PYTHON 906B

HRJ WIDOW MAKER 12A
 PRO-CHAR SALLY 8Y
 TRI-N DIGGER DAN 938W
 BREMNERS SWEETIE 667M
 FFBB RED BUCKLE PLD 16X
 BEAVER CREEK GINGER 271W
 PRO-CHAR CPTN. MORGAN 8U
 TRI-N MONTE PYTHON 1056X

ACT BW	ADJ WW	CE	BW	WW	YW	MILK	MTL
94 lbs	739 lbs	2.8	2.1	46	82	23	46

- Ranks in the top 25% for fat



33a



Lot **34** TRI-N MONTE PYTHON 988G

QPFC772941 - NMF 988G - MARCH 3 2019 - POLLED

TRI-N CAPTAIN MORGAN 340A
TRI-N RED BARON 765E
 TRI-N MISS CHARHEAD 917W

BEAVER CREEK COUNTRY 261A
TRI-N MONTE PYTHON 678D
 TRI-N MONTE PYTHON 906B

PRO-CHAR CPTN. MORGAN 8U
 TRI-N BUFFY 79T
 VAL-END APPRAISER 24J
 CHARHEAD MISS 23R
 FFBB RED BUCKLE PLD 16X
 BEAVER CREEK GINGER 271W
 PRO-CHAR CPTN. MORGAN 8U
 TRI-N MONTE PYTHON 1056X

CE	BW	WW	YW	MILK	MTL
8.2	-2.1	49	87	20	44

- Ranks in the top 15% for birth weight and top 25% for calving ease and marbling
- Her mother, TRI-N Monte Python 678D, sells as lot 33
- **Bred to Jack Foundation 7F on April 11, 2021 – due January 21, 2022**
- **Exposed to Jack Foundation 7F from April 10 to August 2, 2021**
- **Pregnancy examined to the observed date**



34a

Lot 34a TRI-N MONTE PYTHON 6J

QPFC817409 - NMF 6J - FEBRUARY 7 2021 - POLLED

HRJ BULLETPROOF 411B
B&L DARK HORSE 27G
 KLD24C

TRI-N RED BARON 765E
TRI-N MONTE PYTHON 988G
 TRI-N MONTE PYTHON 678D

SPARROWS KINGSTON 139
 HRJ MISS PARIS 7S
 LT LEDGER 0332 P
 KLD ROCKY ACRES 14Y
 TRI-N CAPTAIN MORGAN 340A
 TRI-N MISS CHARHEAD 917W
 BEAVER CREEK COUNTRY 261A
 TRI-N MONTE PYTHON 906B

ACT BW	ADJ WW	CE	BW	WW	YW	MILK	MTL
87 lbs	767 lbs	8.1	-1.4	46	86	21	44

Lot 35 TRI-N MONTE PYTHON 8H

QPFC795931 - NMF 8H - JANUARY 31 2020 - POLLED

TRI-N CAPTAIN MORGAN 340A
TRI-N RED BARON 765E
 TRI-N MISS CHARHEAD 917W

TWN YANGSTER 27Y
TRI-N MONTE PYTHON 619D
 TRI-N MONTE PYTHON 390A

PRO-CHAR CPTN. MORGAN 8U
 TRI-N BUFFY 79T
 VAL-END APPRAISER 24J
 CHARHEAD MISS 23R
 LAE WICHITA 911W
 TWN SABLE 33S
 PRO-CHAR CPTN. MORGAN 8U
 TRI-N MONTE PYTHON 1056X

CE	BW	WW	YW	MILK	MTL
8.1	-2.5	46	82	17	40

- Ranks in the top 10% for birth weight and the top 20% for marbling
- A.I. bred to HVA Fireball 662F on April 24, 2021 – due February 3, 2022
- Exposed to K-Cow Gonzo 413G from May 15 to August 1, 2021
- Pregnancy examined favorable to the A.I. service



35



NMF 93T

The REBA Family

The cow family is responsible for the creation of TRI-N Payday 419P as mentioned in the Monte Python cow family. This cow family is one of Jesse's favorites. They all have small teat size, impeccable udders with that deep, deep flank!

TRI-N Reba 93T a maternal sister to Payday has been sent to Texas A+M University to highlight their embryo program at 14 which you will find there is a heavy influence here. She produced one of the nicest SCX Thriller sons we have raised, Dr. Merv, selling to Beery Ranch (MT). If I was building a herd of cows, I'd purchase a few of these Reba females.



Working at TRI-N



Working at Beery Ranch (MT)

- Ranks in the top 5% for total maternal, 15% milk, and 20% for birth weight, weaning and yearling weight
- A son, TRI-N Gunslinger 38H, was selected by Alan Clarkin, North Wiltshire, Prince Edward Island
- A son, TRI-N Terantino 973G was selected by Heitkamp Farms, Wydmere, North Dakota
- Bred to Jack Foundation 7F on April 10, 2021 – due January 20, 2022
- Exposed to Jack Foundation 7F from April 10 to August 2, 2021
- Pregnancy examined to the observed date



Lot **36**

TRI-N REBA 561C

PFC414422 - NMF 561C - MARCH 17 2015 - POLLED

FFBB RED BUCKLE PLD 16X
BEAVER CREEK COUNTRY 261A
 BEAVER CREEK GINGER 271W

JWX SILVER BUCKLE 524U
 FFBB NAREN ANN PLD 836U
 DIM CREEK REVENUE 430R
 BEAVER CREEK KALEI 251K
 LAE WICHITA 911W
 TWN SABLE 33S
 ROSSO NEW HORIZON 8L
 TRI-N-REBA 19R

TWN YANGSTER 27Y
TRI-N REBA 350A
 TRI-N REBA 78T

CE	BW	WW	YW	MILK	MTL
6.9	-1.2	51	99	26	52

Lot **36a**

TRI-N REBA 41J

QPFC8169000 - NMF 41J - FEBRUARY 18 2021 - POLLED

PRO-CHAR YELLOW JACKET 6C
JACK FOUNDATION 7F
 BREMNERS BRITTANY 348Y

HRJ WIDOW MAKER 12A
 PRO-CHAR SALLY 8Y
 TRI-N DIGGER DAN 938W
 BREMNERS SWEETIE 667M
 FFBB RED BUCKLE PLD 16X
 BEAVER CREEK GINGER 271W
 TWN YANGSTER 27Y
 TRI-N REBA 78T

BEAVER CREEK COUNTRY 261A
TRI-N REBA 561C
 TRI-N REBA 350A

ACTBW	ADJWW	CE	BW	WW	YW	MILK	MTL
86 lbs	835 lbs	5.0	1.0	46	84	23	46





37

Lot **37**

TRI-N REBA 601D

PFC708869 - NMF 601D - FEBRUARY 6 2016 - POLLED

SPARROWS SANCHEZ 715T
CML ENCORE 4Y
 CML PLD WILMA 3S

SOS CRIMSON TIDE 97S
TRI-N REBA 937W
 TRI-N REBA 78T

SPARROWS ALCATRAZ 18N
 SPARROWS DANA 321L
 MERIT VINTAGE 4065P
 TARGET PLD GINNY 40P
 MGM MERLOT
 P-3 LADY PERFECT 6-146F
 ROSSO NEW HORIZON 8L
 TRI-N-REBA 19R

CE	BW	WW	YW	MILK	MTL
5.9	0.8	32	75	22	38

- Her daughter, TRI-N Reba 2435H, sells as lot 38
- A son, TRI-N Pedro 9420G was selected by Beery Ranch, Richey, Montana
- Calved February 2, 2021 froze at birth
- **Bred to SCX Jehu 233E on April 30, 2021 – due February 10, 2022**
- **Exposed to SCX Jehu 233E from April 10 to August 2, 2021**
- **Pregnancy examined to the observed date**

Lot **38**

TRI-N REBA 2435H

PFC795346 - NMF 2435H - MARCH 1 2020 - POLLED

SCR TRIUMPH 2135
SCX JEHU 233E
 SCX MISS MAGNUM 109X

CML ENCORE 4Y
TRI-N REBA 601D
 TRI-N REBA 937W

SCR TUFFY 0119
 SCR MS BABY DOLL 7140
 SCX HILARIO 49T
 SCX MISS CHICO 48P
 SPARROWS SANCHEZ 715T
 CML PLD WILMA 3S
 SOS CRIMSON TIDE 97S
 TRI-N REBA 78T

CE	BW	WW	YW	MILK	MTL
5.5	-0.4	43	95	22	44

- Ranks in the top 25% for yearling weight
- Her mother, TRI-N Reba 601D, sells as lot 37
- **A.I. bred to HVA Fireball 662F on April 15, 2021 – due January 25, 2022**
- **Exposed to K-Cow Gonzo 413G from May 6 to August 1, 2021**
- **Pregnancy examined favorable to the A.I. service**

- Ranks in the top 10% for yearling weight, milk, total maternal and the top 15% for carcass weight, rib-eye, marbling and lean yield
 - Her mother, TRI-N Reba 928W has been a consistent producer with sons selected by MBRHEO Cattle Co., Clifford, Ontario, Paul Bickerton, Elkhorn and A.T. Robson, Minnedosa, Manitoba
 - Bred K-Cow Gonzo 413G on July 6, 2021 – due April 16, 2022
 - Exposed to K-Cow Gonzo 413G from April 20 to August 1, 2021
 -Pregnancy examined favorable to the observed date



Lot **39**

TRI-N REBA 4H

PFC795926 - NMF 4H - JANUARY 30 2020 - POLLED

SCR TRIUMPH 2135
 SCX JEHU 233E
 SCX MISS MAGNUM 109X

SOS CRIMSON TIDE 97S
 TRI-N REBA 928W
 TRI-N-REBA 19R

CE	BW	WW	YW	MILK	MTL
5.4	0.0	48	105	27	51

SCR TUFFY 0119
 SCR MS BABY DOLL 7140
 SCX HILARIO 49T
 SCX MISS CHICO 48P
 MGM MERLOT
 P-3 LADY PERFECT 6-146F
 SDC LAREDO 17N
 TRI-N-GREAT ASTROID 49G

Lot **40**

TRI-N REBA 998G

QPFC771789 - NMF 998G - MARCH 15 2019 - POLLED

WINN MANS MARQUEZ 821U
 WINN MANS TERANTINO 9131Y
 WINN MANS SEDUCTIVE 9131W

SOS CRIMSON TIDE 97S
 TRI-N REBA 928W
 TRI-N-REBA 19R

CE	BW	WW	YW	MILK	MTL
3.4	2.6	54	100	23	49

WINN MANS LANZA 610S
 WINN MANS LA SENZA 435P
 SPARROWS CAJUN 485N
 WINN MAN SEDUCTIVE 052K
 MGM MERLOT
 P-3 LADY PERFECT 6-146F
 SDC LAREDO 17N
 TRI-N-GREAT ASTROID 49G

-Ranks in top 15% for weaning weight, total maternal and carcass weight and top 20% yearling weight, rib-eye and lean meat yield.
 -Dam is a Gold Star Dam of Distinction with sons selling to Robson Farms, MBRHEO Cattle (ON), Paul Bickerton and the TRI-N commercial herd.
 - Bred SCX Jehu 2 236G on May 10 (Due Feb 20).
 - Exposed to same from April 10- August 2, 2021
 - Pregnancy examined favorable to the observed date





Lot **41**

TRI-N REBA 962G

QPFC771734 - NMF 962G - FEBRUARY 23 2019 - POLLED

WINN MANS MARQUEZ 821U
WINN MANS TERANTINO 9131Y
 WINN MANS SEDUCTIVE 9131W

TWN YANGSTER 27Y
TRI-N REBA 635D
 TRI-N REBA 93T

WINN MANS LANZA 610S
 WINN MANS LA SENZA 435P
 SPARROWS CAJUN 485N
 WINN MAN SEDUCTIVE 052K
 LAE WICHITA 911W
 TWN SABLE 33S
 SDC LAREDO 17N
 TRI-N-GREAT ASTROID 49G

CE	BW	WW	YW	MILK	MTL
6.9	0.9	54	93	17	44

- Ranks in the top 10% of the breed for weaning weight
- Calved February 7, 2021 Bull calf sired by McTavish Icon 20G BW: 91 lbs. Adj-205 day wt: 782 lbs.
- **A.I. bred to SCX Jehu 233E on April 16, 2021 – due January 26, 2022**
- **Exposed to SCX Jehu 2 236G from April 30 to August 2, 2021**
- **Pregnancy examined to the A.I. service**



Jesse Nykolaitis

NMF 72T

The MARLENE Family

Just like the Monte Python and Reba cow families, the Marlene cow family started with the purchase of Border Corner Astra 1X from the 49ers female sale in 1989 at Alameda, SK. These females all trace back to the Marlene 72T cow which was one of Jesse's favorite tan Charolais females of all time. A cow that should have been flushed. A lot of calving ease and strong maternal in these genetics.



Working at Graf Charolais (ND)



Working at Lynn Cattle Co. (SK)



42

Lot 42 TRI-N MARLENE 604D

QPFC708872 - NMF 604D - FEBRUARY 7 2016 - POLLED

PRO-CHAR CPTN. MORGAN 8U
TRI-N CAPTAIN MORGAN 340A
 TRI-N BUFFY 79T

TRI-N-PAYDAY 419P
TRI-N MARLENE 72T
 TRI-N-MARLENE 234M

HARVIE REDEMPTION 36P
 EFH DAISY MAE 30J
 TRI-N-PAYDAY 419P
 TRI-N BUFFY 6R
 SDC PROGRESS 16M
 TRI-N-GREAT ASTROID 49G
 TRI-N-SUPER JAMMER 7J
 TRI-N-KANDY 25K

CE	BW	WW	YW	MILK	MTL
7.2	-0.5	49	88	21	46

- Two daughters sell, TRI-N Marlene 19H, as lot 44 and TRI-N Marlene 941G as lot 43
- A son, TRI-N Upper Cut 829F, was selected by Rockin T Ranch, Lindsay, Oklahoma
- Chris Poleys pick of the dark red cows when touring this summer
- Calved March 5, 2021 Bull calf sired by Jack Foundation 7F BW: 90 lbs. Adj-205 day wt: 839 lbs. Feature in 2022 bull sale.
- **Bred to Jack Foundation 7F on April 11, 2021 – due January 21, 2022**
- **Exposed to Jack Foundation 7F from April 10 to August 2, 2021**
- **Pregnancy examined to the observed date**

Lot 43 TRI-N MARLENE 941G

QPFC771736 - NMF 941G - FEBRUARY 23 2019 - POLLED

WINN MANS MARQUEZ 821U
WINN MANS TERANTINO 9131Y
 WINN MANS SEDUCTIVE 9131W

TRI-N CAPTAIN MORGAN 340A
TRI-N MARLENE 604D
 TRI-N MARLENE 72T

WINN MANS LANZA 610S
 WINN MANS LA SENZA 435P
 SPARROWS CAJUN 485N
 WINN MAN SEDUCTIVE 052K
 PRO-CHAR CPTN. MORGAN 8U
 TRI-N BUFFY 79T
 TRI-N-PAYDAY 419P
 TRI-N-MARLENE 234M

CE	BW	WW	YW	MILK	MTL
8.1	-1.1	59	94	17	46

- Her mother, TRI-N Marlene 604D, sells as lot 42
- Ranks in the top 4% for weaning weight and top 20% birth weight
- Calved January 22, 2021 calf dead at birth
- **A.I. bred to SCX Jehu 233E on April 16, 2021 – due January 26, 2022**
- **Exposed to SCX Jehu 2 236G from April 30 to August 2, 2021**
- **Pregnancy examined to the A.I. date**

- Her mother, TRI-N Marlene 604D, sells as lot 42- ranks in the top 5% for birth weight and top 15% for calving ease
- Bred to Circle Cee Amplify 16H on April 15, 2021
- Due January 25, 2022
- Exposed to Circle Cee Amplify 16H from May 6 to August 1, 2021
- Pregnancy examined favorable to the observed date



44

Lot 44 TRI-N MARLENE 19H

QPFC797987 - NMF 19H - FEBRUARY 5 2020 - POLLED

TRI-N CAPTAIN MORGAN 340A
TRI-N RED BARON 765E
 TRI-N MISS CHARHEAD 917W

TRI-N CAPTAIN MORGAN 340A
TRI-N MARLENE 604D
 TRI-N MARLENE 72T

PRO-CHAR CPTN. MORGAN 8U
 TRI-N BUFFY 79T
 VAL-END APPRAISER 24J
 CHARHEAD MISS 23R

PRO-CHAR CPTN. MORGAN 8U
 TRI-N BUFFY 79T
 TRI-N-PAYDAY 419P
 TRI-N-MARLENE 234M

CE	BW	WW	YW	MILK	MTL
10.3	-3.6	40	70	19	39

Lot 45 TRI-N MARLENE 930G

PFC771729 - NMF 930G - FEBRUARY 15 2019 - POLLED

WINN MANS MARQUEZ 821U
WINN MANS TERANTINO 9131Y
 WINN MANS SEDUCTIVE 9131W

TRI-N-PAYDAY 419P
TRI-N MARLENE 72T
 TRI-N-MARLENE 234M

WINN MANS LANZA 610S
 WINN MANS LA SENZA 435P
 SPARROWS CAJUN 485N
 WINN MAN SEDUCTIVE 052K
 SDC PROGRESS 16M
 TRI-N-GREAT ASTROID 49G
 TRI-N-SUPER JAMMER 7J
 TRI-N-KANDY 25K

CE	BW	WW	YW	MILK	MTL
9.8	-2.1	45	73	23	46

- Ranks in the top 15% of the breed for calving ease and birth weight
- Her maternal sisters sell, TRI-N Marlene 604D, sells as lot 42 and TRI-N Marlene 91H as lot 46
- A.I. bred to SCX Jehu 233E on April 12, 2021
- Due January 22, 2022
- Exposed to SCX Jehu 2 236G from April 26 to August 2, 2021
- Pregnancy examined to the A.I. date



45



45a

Lot 45a TRI-N MARLENE 60J

QPFC797987 - NMF 60J - FEBRUARY 5 2020 - POLLED

SOS HOOEY PLD 127D
MCTAVISH ICON 20G
MCTAVISH FAYE 93E

WINN MANS CHAVEZ 826Y
FFBB ABBI 307A
WINN MANS CUERVO 4A
MCTAVISH FAYE 37X

WINN MANS TERANTINO 9131Y
TRI-N MARLENE 930G
TRI-N MARLENE 72T

WINN MANS MARQUEZ 821U
WINN MANS SEDUCTIVE 9131W
TRI-N-PAYDAY 419P
TRI-N-MARLENE 234M

ACTBW	ADJWW	CE	BW	WW	YW	MILK	MTL
80 lbs	871 lbs	8.1	-0.5	42	77	19	40

Lot 46 TRI-N MARLENE 91H

QPFC798112 - NMF 91H - MARCH 15 2020 - POLLED

TRI-N CAPTAIN MORGAN 340A
TRI-N RED BARON 765E
TRI-N MISS CHARHEAD 917W

PRO-CHAR CPTN. MORGAN 8U
TRI-N BUFFY 79T
VAL-END APPRAISER 24J
CHARHEAD MISS 23R

TRI-N-PAYDAY 419P
TRI-N MARLENE 72T
TRI-N-MARLENE 234M

SDC PROGRESS 16M
TRI-N-GREAT ASTROID 49G
TRI-N-SUPER JAMMER 7J
TRI-N-KANDY 25K

CE	BW	WW	YW	MILK	MTL
10.8	-2.6	45	74	21	43

- Ranks in the top 10% for birth weight and calving ease
- Her mother is the dam of TRI-N Mr Cool 764E, herd sire at Graf Charolais Ranch, Burlington, North Dakota along with sons selected by Kris O'Greysik, Donald Lewis and Roger and Carol Richard
- **A.I. bred to HVA Fireball 662F on April 9, 2021 – due January 19, 2022**
- **Exposed to K-Cow Gonzo 413G from April 30 to August 1, 2021**
- **Pregnancy examined favorable to the A.I. service**

Lot 47 TRI-N MARLENE 52H

PFC798054 - NMF 52H - FEBRUARY 21 2020 - POLLED

SCR TRIUMPH 2135
SCX JEHU 233E
SCX MISS MAGNUM 109X

SCR TUFFY 0119
SCR MS BABY DOLL 7140
SCX HILARIO 49T
SCX MISS CHICO 48P

TWN YANGSTER 27Y
TRI-N MARLENE 510C
TRI-N MARLENE 72T

LAE WICHITA 911W
TWN SABLE 33S
TRI-N-PAYDAY 419P
TRI-N-MARLENE 234M

CE	BW	WW	YW	MILK	MTL
7.7	-1.2	48	97	21	45

- Ranks in the top 20% for birth weight and the top 25% for yearling weight
- Her mother, produced TRI-N Streveler 897F selected by Lawrence Schann, Young, Saskatchewan and TRI-N Backwoods 795E selected by Dynamic Z Charolais, Lake Park, Iowa
- **A.I. bred to HVA Fireball 662F on April 9, 2021 – due January 19, 2022**
- **Exposed to K-Cow Gonzo 413G from April 30 to August 1, 2021**
- **Pregnancy examined favorable to the A.I. service**



47

Lot 48 TRI-N MARLENE 530C

PFC414413 - NMF 530C - FEBRUARY 25 2015 - POLLED

SPARROWS SANCHEZ 715T
CML ENCORE 4Y
 CML PLD WILMA 3S

SPARROWS ALCATRAZ 18N
 SPARROWS DANA 321L
 MERIT VINTAGE 4065P
 TARGET PLD GINNY 40P
 HARVIE REDEMPTION 36P
 EFH DAISY MAE 30J
 TRI-N-PAYDAY 419P
 TRI-N-MARLENE 234M

PRO-CHAR CPTN. MORGAN 8U
TRI-N MARLENE 371A
 TRI-N MARLENE 72T

CE	BW	WW	YW	MILK	MTL
2.1	2.5	36	73	21	39

- Her daughter, TRI-N Marlene 1014G, as lot 49
- A son, TRI-N Little Rock 25H, was selected by Lee Woloshyn, Fisher Branch, Manitoba
- **Bred to SCX Jehu 233E on April 12, 2021 – due January 22, 2022**
- **Exposed to SCX Jehu 233E from April 10 to August 2, 2021**
- **Pregnancy examined favorable to the observed date**



48

Lot 48a TRI-N MARLENE 122J

PFC816940 - NMF 122J - MARCH 20 2021 - POLLED

SCR TRIUMPH 2135
SCX JEHU 233E
 SCX MISS MAGNUM 109X

SCR TUFFY 0119
 SCR MS BABY DOLL 7140
 SCX HILARIO 49T
 SCX MISS CHICO 48P
 SPARROWS SANCHEZ 715T
 CML PLD WILMA 3S
 PRO-CHAR CPTN. MORGAN 8U
 TRI-N MARLENE 72T

CML ENCORE 4Y
TRI-N MARLENE 530C
 TRI-N MARLENE 371A

ACTBW	ADJWW	CE	BW	WW	YW	MILK	MTL
100 lbs	777 lbs	3.6	0.9	50	101	21	46

- Ranks in the top 15% for yearling weight, the top 20% for carcass weight and the top 25% for weaning weight



48a

Lot 49 TRI-N MARLENE 1014G

PFC773044 - NMF 1014G - MARCH 26 2019 - POLLED

WINN MANS MARQUEZ 821U
WINN MANS TERANTINO 9131Y
 WINN MANS SEDUCTIVE 9131W

WINN MANS LANZA 610S
 WINN MANS LA SENZA 435P
 SPARROWS CAJUN 485N
 WINN MAN SEDUCTIVE 052K
 SPARROWS SANCHEZ 715T
 CML PLD WILMA 3S
 PRO-CHAR CPTN. MORGAN 8U
 TRI-N MARLENE 72T

CML ENCORE 4Y
TRI-N MARLENE 530C
 TRI-N MARLENE 371A

CE	BW	WW	YW	MILK	MTL
2.6	2.8	52	91	17	43

- Ranks in the top 20% of the breed for weaning weight
- Her mother, TRI-N Marlene 530C, sells as lot 48
- Calved February 19, 2021 Heifer calf sired by McTavish Icon 20G BW: 76 lbs. Adj-205 day wt: 734 lbs.
- **A.I. bred to SCX Jehu 233E on April 16, 2021 – due January 26, 2022**
- **Exposed to SCX Jehu 2 236G from April 30 to August 2, 2021**
- **Pregnancy examined to the A.I. date**



49



Lot 50 TRI-N MARLENE 913G

QPFC771725 - NMF 913G - FEBRUARY 10 2019 - POLLED

WINN MANS MARQUEZ 821U
WINN MANS TERANTINO 9131Y
 WINN MANS SEDUCTIVE 9131W

WINN MANS LANZA 610S
 WINN MANS LA SENZA 435P
 SPARROWS CAJUN 485N
 WINN MAN SEDUCTIVE 052K
 HARVIE REDEMPTION 36P
 EFH DAISY MAE 30J
 TRI-N-PAYDAY 419P
 TRI-N-MARLENE 234M

PRO-CHAR CPTN. MORGAN 8U
TRI-N MARLENE 371A
 TRI-N MARLENE 72T

CE	BW	WW	YW	MILK	MTL
7.1	-0.3	50	82	18	43

- Ranks in the top 25% of the breed for weaning weight
- Calved January 29, 2021 Heifer calf sired McTavish Icon 20G BW: 77 lbs. Adj-205 day wt: 653 lbs.
- **A.I. bred to SCX Jehu 233E on April 26, 2021 – due February 6, 2022**
- **Exposed to SCX Jehu 2 236G from May 10 to August 2, 2021**
- **Pregnancy examined to the A.I. date**



Lot 51 TRI-N MARLENE 403B

PFC409175 - NMF 403B - FEBRUARY 5 2014 - POLLED

HVA UPSTATE 8U
MVY XPLOER 21X
 BAR EW TANYA 13T

SDC PROGRESS 16M
TRI-N-MARLENE 408P
 TRI-N-MARLENE 234M

WHITECAP JUSTICE 67R
 HVA PANSY 8P
 LAE PARAGON 404P
 BAR E W HW 86H
 MSW Y2K
 SDC MISS GYPSY 40J
 TRI-N-SUPER JAMMER 7J
 TRI-N-KANDY 25K

CE	BW	WW	YW	MILK	MTL
12.3	-4.1	29	40	22	37

- Ranks in the top 3% of the breed for birth weight and 5% for calving ease
- Sons have been selected by Lynn Cattle Co. Inc., Marquis, Saskatchewan and Robert Elliott, Carberry, Manitoba
- Calved February 24, 2021 Bull calf sired by SCX Jehu 233E BW: 90 lbs. Adj-205 day wt: 897 lbs. Feature in 2022 bull sale.
- **Bred to SCX Jehu 233E on April 13, 2021 – due January 23, 2022**
- **Exposed to SCX Jehu 233E from April 10 to August 2, 2021**
- **Pregnancy examined favorable to the observed date**



Lot 52 TRI-N MARLENE 1010G

PFC771627 - NMF 1010G - MARCH 23 2019 - POLLED

LT LEDGER 0332 P
CFC ALREADY PLATINUM 167D
 CFC WYOMING WIND 42N

HRJ BULLETPROOF 411B
TRI-N MARLENE 729E
 TRI-N-MARLENE 408P

LT BLUEGRASS 4017 P
 LT BRENDA 6120 PLD
 LT WYOMING WIND 4020 PLD
 CFC PERFECTION 1K
 SPARROWS KINGSTON 139Y
 HRJ MISS PARIS 7S
 SDC PROGRESS 16M
 TRI-N-MARLENE 234M

CE	BW	WW	YW	MILK	MTL
8.7	0.6	36	63	22	40

- Ranks in the top 25% of the breed for calving ease, rib-eye and fat
- Calved February 18, 2021 Bull calf sired by McTavish Icon 20G BW: 85 lbs. Adj-205 day wt: 735 lbs.
- **A.I. bred to SCX Jehu 233E on April 17, 2021 – due January 27, 2022**
- **Exposed to SCX Jehu 2 236G from May 1 to August 2, 2021**
- **Pregnancy examined to the A.I. date**



The RATIONELLE Family

Another descendant of the Border Corner Astra 1X Female just like the Monte Python, Reba and Marlene cow families... wow!!

This cow family was named after TRI-N Rationelle 26R, a Gold Star Dam that produced a calf every year until she was 14. Her daughter, 97T was an excellent cow as well producing until 12 and was a Gold Star Dam. This cow family can be found in our newest feature red factor sire Jacks Foundation 7F.



Working at TRI-N



Working at Walters Charolais (ND)



- Ranks in the top 3% of the breed for birth weight and the top 10% for calving ease and weaning weight
- Maternal brothers were selected by Jeff Smith Sundre, Alberta, Michael Wiebe, Portage La Prairie, Manitoba and Walters Charolais, Minot, North Dakota
- Calved February 26, 2021
- Bull calf sired by McTavish Icon 20G BW: 82 lbs. Adj-205 day wt: 931 lbs.
- A.I. bred to SCX Jehu 233E on April 16, 2021
- Due January 26, 2022
- Exposed to SCX Jehu 233E from April 10 to August 2, 2021
- Pregnancy examined to the A.I. date

Lot 53 TRI-N RATIONELLE 9429G

QPFC772204 - NMF 9429G - FEBRUARY 28 2019 - POLLED

TRI-N CAPTAIN MORGAN 340A
TRI-N RED BARON 765E
 TRI-N MISS CHARHEAD 917W

TRI-N-PAYDAY 419P
TRI-N RATIONELLE 97T
 TRI-N-RATIONELLE 26R

PRO-CHAR CPTN. MORGAN 8U
 TRI-N BUFFY 79T
 VAL-END APPRAISER 24J
 CHARHEAD MISS 23R
 SDC PROGRESS 16M
 TRI-N-GREAT ASTROID 49G
 TRI-N-SUPER JAMMER 7J
 TRI-N-LITTLE KIM 13K

CE	BW	WW	YW	MILK	MTL
12.0	-4.1	55	90	19	46

Lot 54 TRI-N RATIONELLE 928G

PFC771694 - NMF 928G - FEBRUARY 13 2019 - POLLED

TRI-N THRILLER PLD 173Z
SCX THRILLER 89B
 BWK BURST MARBLER 1149

PRO-CHAR CPTN. MORGAN 8U
TRI-N RATIONELLE 347A
 TRI-N-RATIONELLE 26R

TRI-N-SUPER JAMMER 7J
 TRI-N CREAMSICLE 85T
 FC MARBLER 864 P
 LJK MISS STARBURST 4006
 HARVIE REDEMPTION 36P
 EFH DAISY MAE 30J
 TRI-N-SUPER JAMMER 7J
 TRI-N-LITTLE KIM 13K

CE	BW	WW	YW	MILK	MTL
5.9	0.7	53	98	24	51



- Ranks in the top 10% of the breed for total maternal, top 15% for weaning weight, the top 20% for yearling weight and the top 25% for milk and carcass weight
- Her mother, TRI-N Rationelle 347A, is the dam of herd bulls for Francrest Farms, Wingham, Ontario and Clayton Toms, Redvers, Saskatchewan
- Calved January 25, 2021 calf died at birth froze
- A.I. bred to SCX Jehu 233E on April 12, 2021
- Due January 22, 2022
- Exposed to SCX Jehu 2 236G from April 26 to August 2, 2021
- Pregnancy examined to the A.I. date

- Ranks in the top 2% of the breed for birth weight and the top 5% for calving ease
 - Her maternal brother was selected by Janet Hamilton, Wawanesa, Manitoba
 - Calved February 1, 2021 calf froze at birth - raised foster calf weighing 683 lb. on September 15th
 - A.I. bred to SCX Jehu 233E on April 26, 2021
 - Due February 5, 2022
 - Exposed to SCX Jehu 2 236G from May 9 to August 2, 2021
 - Pregnancy examined to the A.I. date



Lot 55 TRI-N RATIONELLE 1009G

QPFC773041 - NMF 1009G - MARCH 23 2019 - POLLED

TRI-N CAPTAIN MORGAN 340A
TRI-N RED BARON 765E
 TRI-N MISS CHARHEAD 917W

PRO-CHAR CPTN. MORGAN 8U
TRI-N RATIONELLE 157Z
 TRI-N RATIONELLE 97T

PRO-CHAR CPTN. MORGAN 8U
 TRI-N BUFFY 79T
 VAL-END APPRAISER 24J
 CHARHEAD MISS 23R
 HARVIE REDEMPTION 36P
 EFH DAISY MAE 30J
 TRI-N-PAYDAY 419P
 TRI-N-RATIONELLE 26R

CE	BW	WW	YW	MILK	MTL
12.4	-4.6	45	76	16	39

Lot 56 TRI-N RATIONELLE 1030G

PFC771727 - NMF 1030G - APRIL 7 2019 - POLLED

WINN MANS MARQUEZ 821U
WINN MANS TERANTINO 9131Y
 WINN MANS SEDUCTIVE 9131W

BEAVER CREEK HARD-CORE299
TRI-N RATIONELLE 81Y
 TRI-N RATIONELLE 97T

WINN MANS LANZA 610S
 WINN MANS LA SENZA 435P
 SPARROWS CAJUN 485N
 SCX MISS CHICO 48P
 DIM CREEK REVENUE 430R
 BEAVER CREEK MISS 233S
 TRI-N-PAYDAY 419P
 TRI-N-RATIONELLE 26R

CE	BW	WW	YW	MILK	MTL
7.8	-0.5	60	92	16	46

-Ranks in top 3% for weaning weight.
 - Bred SCX Jehu 2 236G on May 11
 - Due February, 2021
 - Exposed to same from April 10 to August 2, 2021
 - Pregnancy examined favorable to the observed date





The SALLY Family

The Sally cow family also traces back to Merv's first purchase in 1984... Miss DTM 18L just like the Prairie Rose, Creamsicle and Nickheata cow families. This cow family traces back to TRI-N Sally 41S who was one of the soundest, nicest cows to walk our pastures and was a Gold Star Dam of Distinction. A maternal sis to 41S, 463B (the dam of NMF 21H selling) will be entering our donor program very soon. The first time we have ever offered any females for sale from this long running cow family.



Working at Triple C Charolais (MB)



Working at Rockin X5 (ND)



Lot **57**

TRI-N SALLY 21H

PFC797989 - NMF 21H - FEBRUARY 8 2020 - POLLED

SCR TRIUMPH 2135
SCX JEHU 233E
 SCX MISS MAGNUM 109X

MVY XPLOER 21X
TRI-N KOREEN 463B
 TRI-N-KOREEN 410P

SCR TUFFY 0119
 SCR MS BABY DOLL 7140
 SCX HILARIO 49T
 SCX MISS CHICO 48P
 HVA UPSTATE 8U
 BAR EW TANYA 13T
 SDC PROGRESS 16M
 TRI-N-SWEET CORONA 305M

CE	BW	WW	YW	MILK	MTL
9.4	-3.3	53	96	21	48

- Ranks in the top 10% of the breed for birth weight, the top 15% for weaning weight, the top 20% for calving ease and total maternal and the top 25% for yearling weight
- Maternal brother, TRI-N Cuervo 915G, was selected by Hudson Schaan, Young, Saskatchewan
- **A.I. bred to HVA Fireball 662F on April 9, 2021 – due January 19, 2022**
- **Exposed to K-Cow Gonzo 413G from April 30 to August 1, 2021**
- **Pregnancy examined favorable to the A.I. service**



- Ranks in the top 1% of the breed for yearling weight, the top 5% for weaning weight, the top 10% for carcass weight, rib-eye, lean yield and the top 15% for total maternal and marbling
- Maternal brothers have been selected by Sean Tolton, Kenton, Manitoba and Gordon Dickson, Wawota, Saskatchewan
- A.I. bred to HVA Fireball 662F on April 10, 2021 - Due January 20, 2022
- Exposed to K-Cow Gonzo 413G from May 1 to August 1, 2021
- Pregnancy examined favorable to the A.I. service

Lot 58 TRI-N SALLY 66H
QPFC798069 - NMF 66H - FEBRUARY 28 2020 - POLLED

SCR TRIUMPH 2135
 SCX JEHU 233E
 SCX MISS MAGNUM 109X

SCR TUFFY 0119
 SCR MS BABY DOLL 7140
 SCX HILARIO 49T
 SCX MISS CHICO 48P
 SOS CRIMSON TIDE 97S
 TRI-N EASY GIRL 95T
 SOS CRIMSON TIDE 97S
 TRI-N SALLY 41S

TRI-N TIDAL WAVE 960W
 TRI-N SALLY 135Y
 TRI-N SALLY 934W

CE	BW	WW	YW	MILK	MTL
5.1	0.9	58	120	20	49

Lot 59 TRI-N SALLY 41H
QPFC798038 - NMF 41H - FEBRUARY 16 2020 - POLLED

HEJ CHESTER 1C
 HEJ EINSTEIN 28E
 HEJ CATALINA SUNRISE 68C

HEJ ARMAGEDDON 84A
 HEJ MURPHY 61A
 ANCHOR J JIMMY 15Y
 HEJ TEQUILA SUNRISE 76Y
 FFBB RED BUCKLE PLD 16X
 BEAVER CREEK GINGER 271W
 TWN YANGSTER 27Y
 TRI-N SALLY 934W

BEAVER CREEK COUNTRY 261A
 TRI-N SALLY 724E
 TRI-N SALLY 562C

CE	BW	WW	YW	MILK	MTL
5.9	1.0	48	95	17	41



- Ranks in the top 25% of the breed for yearling weight and marbling
- A.I. bred to HVA Fireball 662F on April 9, 2021 - Due January 19, 2022
- Exposed to K-Cow Gonzo 413G from April 30 to August 1, 2021
- Pregnancy examined favorable to the A.I. service



Katie Johnson

Raised by
Odden Charolais
(SD)

The NICKHEATA Family

A descendant of the original purchase Miss DTM 18L just like the Prairie Rose, Creamsicle and Sally cow families. This family was named after TRI-N Nickheata 326N, the recip cow that raised TRI-N Prefix the high priced Charolais bull in 2012. She also produced TRI-N Xplorer 453B, which is working for Odden Charolais (SD USA). He produced the \$27,500 USD daughter for Oddens in the inaugural female sale held in conjunction with Doonan Cattle Co in Texas. She ended up being the reserve champion female at the American Royal show. Big bodied, low maintenance females that milk well and carry that banner winning style.



Jesse Nykall
Working at Odden Charolais (SD)



Jesse Nykall
Working at TRI-N



- Ranks in the top 1% for birth weight, the top 2% for calving ease and the top 15% for marbling
- Her maternal sister, TRI-N Nickheata 956G, sells as lot 64
- A son, TRI-N Eastwood 22H, was selected by Windin B Cattle, Centerville, Kansas
- Bred to Jack Foundation 7F on June 1, 2021
- Due March 11, 2022
- Exposed to Jack Foundation 7F from April 10 to August 2, 2021
- Pregnancy examined to the observed date

Lot 60 TRI-N NICKHEATA 846F

QPFC750497 - NMF 846F - FEBRUARY 18 2018 - POLLED

PRO-CHAR CPTN. MORGAN 8U
TRI-N CAPTAIN MORGAN 340A
 TRI-N BUFFY 79T

HARVIE REDEMPTION 36P
 EFH DAISY MAE 30J
 TRI-N-PAYDAY 419P
 TRI-N BUFFY 6R
 MGM MERLOT
 P-3 LADY PERFECT 6-146F
 SDC LAREDO 17N
 TRI-N-NICKHEATA 326N

SOS CRIMSON TIDE 97S
TRI-N NICKHEATA 950W
 TRI-N NICKHEATA 98T

CE	BW	WW	YW	MILK	MTL
14.1	-5.9	49	87	18	43

Lot 60a TRI-N NICKHEATA 47J

PFC818006 - NMF 47J - FEBRUARY 20 2021 - POLLED

SCR TRIUMPH 2135
SCX JEHU 233E
 SCX MISS MAGNUM 109X

TRI-N CAPTAIN MORGAN 340A
TRI-N NICKHEATA 846F
 TRI-N NICKHEATA 950W

SCR TUFFY 0119
 SCR MS BABY DOLL 7140
 SCX HILARIO 49T
 SCX MISS CHICO 48P
 PRO-CHAR CPTN. MORGAN 8U
 TRI-N BUFFY 79T
 SOS CRIMSON TIDE 97S
 TRI-N NICKHEATA 98T

ACT BW	ADJ WW	CE	BW	WW	YW	MILK	MTL
85 lbs	772 lbs	9.5	-3.2	56	108	19	47



- Ranks in the top 10% for birth weight, weaning weight and yearling weight, the top 20% for calving ease and the top 25% for marbling

Lot 61 TRI-N NICKHEATA 984G

OPFC772932 - NMF 984G - MARCH 1 2019 - POLLED

TRI-N CAPTAIN MORGAN 340A
TRI-N RED BARON 765E
 TRI-N MISS CHARHEAD 917W

VAL-END APPRAISER 24J
TRI-N NICKHEATA PLD 160Z
 TRI-N NICKHEATA 1057X

PRO-CHAR CPTN. MORGAN 8U
 TRI-N BUFFY 79T
 VAL-END APPRAISER 24J
 CHARHEAD MISS 23R
 BUTTE LEE DESIGNER 62D
 VAL-END XAVIER 50D
 SOS CRIMSON TIDE 97S
 TRI-N NICKHEATA 98T

CE	BW	WW	YW	MILK	MTL
9.6	-0.8	37	73	19	37

- Ranks in the top 20% for calving ease and the top 25% for birth weight and marbling
- Her mother, TRI-N Nickheata PLD 160Z, produced sons selected by Brad Thompson, Ron Beery and Darin & Jackie Becker
- Calved March 6, 2021 Bull Calf sired by B&L Dark Horse 27G BW: 92 lbs. Adj-205 day wt: 739 lbs.
- **Bred to Jack Foundation 7F on April 10, 2021 – due January 20, 2022**
- **Exposed to Jack Foundation 7F from April 10 to August 2, 2021**
- **Pregnancy examined to the observed date**



Lot 62 TRI-N NICKHEATA 15H

OPFC795938 - NMF 15H - FEBRUARY 3 2020 - POLLED

TRI-N CAPTAIN MORGAN 340A
TRI-N RED BARON 765E
 TRI-N MISS CHARHEAD 917W

VAL-END APPRAISER 24J
TRI-N NICKHEATA PLD 160Z
 TRI-N NICKHEATA 1057X

PRO-CHAR CPTN. MORGAN 8U
 TRI-N BUFFY 79T
 VAL-END APPRAISER 24J
 CHARHEAD MISS 23R
 BUTTE LEE DESIGNER 62D
 VAL-END XAVIER 50D
 SOS CRIMSON TIDE 97S
 TRI-N NICKHEATA 98T

CE	BW	WW	YW	MILK	MTL
9.8	-1.4	39	76	18	38

- Ranks in the top 20% for birth weight, top 15% for calving ease and 25% for marbling
- **Bred to Circle Cee Amplify 16H on May 5, 2021 – due February 15, 2022**
- **Exposed to Circle Cee Amplify 16H from April 20 to August 1, 2021**
- **Pregnancy examined favorable to the observed date**



Lot 63 TRI-N NICKHEATA 13H

OPFC795936 - NMF 13H - FEBRUARY 3 2020 - POLLED

TRI-N CAPTAIN MORGAN 340A
TRI-N RED BARON 765E
 TRI-N MISS CHARHEAD 917W

TRI-N CAPTAIN MORGAN 340A
TRI-N NICKHEATA 612D
 TRI-N NICKHEATA PLD 160Z

PRO-CHAR CPTN. MORGAN 8U
 TRI-N BUFFY 79T
 VAL-END APPRAISER 24J
 CHARHEAD MISS 23R
 PRO-CHAR CPTN. MORGAN 8U
 TRI-N BUFFY 79T
 VAL-END APPRAISER 24J
 TRI-N NICKHEATA 1057X

CE	BW	WW	YW	MILK	MTL
10.0	-2.7	40	74	15	35

- Ranks in the top 10% for birth weight, top 15% for calving ease and 20% for marbling
- Her mother, TRI-N Nickheata 612D, is the dam of TRI-N Rave On 867F selected by TJ Steele, Newell, South Dakota
- **Bred to Circle Cee Amplify 16H on April 10, 2021 – due January 20, 2022**
- **Exposed to Circle Cee Amplify 16H from May 1 to August 1, 2021**
- **Pregnancy examined favorable to the observed date**





65a

Lot 64 TRI-N NICKHEATA 956G

QPFC771733 - NMF 956G - FEBRUARY 21 2019 - POLLED

WINN MANS MARQUEZ 821U
WINN MANS TERANTINO 9131Y
 WINN MANS SEDUCTIVE 9131W

WINN MANS LANZA 610S
 WINN MANS LA SENZA 435P
 SPARROWS CAJUN 485N
 WINN MAN SEDUCTIVE 052K

SOS CRIMSON TIDE 97S
TRI-N NICKHEATA 950W
 TRI-N NICKHEATA 98T

MGM MERLOT
 P-3 LADY PERFECT 6-146F
 SDC LAREDO 17N
 TRI-N-NICKHEATA 326N

CE	BW	WW	YW	MILK	MTL
11.8	-3.4	46	81	20	43

- Ranks in the top 5% of the breed for birth weight and 10% calving ease
- Her maternal sister, TRI-N Nickheata 846F, sells as lot 60
- Her mother, TRI-N Nickheata 950W, a high earning producer of herd bulls and the dam of TRI-N Go North 731E at Charla Moore, Redvers, Saskatchewan; TRI-N Rockefeller PLD 607D, used extensively in the TRI-N program; TRI-N Xplorer 460B working for Tyrell Neidhardt, Hebron, North Dakota and TRI-N Red Jagger 136Y at Rock'n G Ranch, Baldur, Manitoba
- Calved February 18, 2021 Heifer calf sired by McTavish Icon 20G BW: 94 lbs. Adj-205 day wt: 644 lbs.
- A.I. bred to SCX Jehu 233E on April 16, 2021 – due January 26, 2022
- Exposed to SCX Jehu 2 236G from April 30 to August 2, 2021
- Pregnancy examined to the A.I. date

Lot 65 TRI-N NICKHEATA 958G

PFC771622 - NMF 958G - FEBRUARY 21 2019 - POLLED

LT LEDGER 0332 P
CFC ALREADY PLATINUM 167D
 CFC WYOMING WIND 42N

LT BLUEGRASS 4017 P
 LT BRENDA 6120 PLD
 LT WYOMING WIND 4020 PLD
 CFC PERFECTION 1K

BEAVER CREEK COUNTRY 261A
TRI-N NICKHEATA 726E
 TRI-N NICKHEATA PLD 538C

FFBB RED BUCKLE PLD 16X
 BEAVER CREEK GINGER 271W
 TRI-N CAPTAIN MORGAN 340A
 TRI-N NICKHEATA PLD 160Z

CE	BW	WW	YW	MILK	MTL
6.2	2.5	39	76	21	40

- Ranks in the top 10% of the breed for rib-eye and marbling and the top 15% for lean yield
- A.I. bred to SCX Jehu 233E on April 16, 2021 – due January 28, 2022
- Exposed to SCX Jehu 2 236G from April 30 to August 2, 2021
- Pregnancy examined to the A.I. date



65

Lot 65a TRI-N NICKHEATA 9J

APPLIED FOR - NMF 9J - FEBRUARY 8 2021 - POLLED

SOS HOOEY PLD 127D
MCTAVISH ICON 20G
 MCTAVISH FAYE 93E

WINN MANS CHAVEZ 826Y
 FFBB ABBI 307A
 WINN MANS CUERVO 4A
 MCTAVISH FAYE 37X

CFC ALREADY PLATINUM 167D
TRI-N NICKHEATA 958G
 TRI-N NICKHEATA 726E

LT LEDGER 0332 P
 CFC WYOMING WIND 42N
 BEAVER CREEK COUNTRY 261A
 TRI-N NICKHEATA PLD 538C

ACT BW	ADJ WW	CE	BW	WW	YW	MILK	MTL
89 lbs	724 lbs	9.1	-2.1	45	87	24	46



The **BARBRA ANNE** Family

One of our newer cow families that's small in numbers but super impressive. Merv selected a top female from Bremner Charolais, Dauphin based on my good friend Jack's advice. She ended up being exactly what Jack said. These females have tight udders, small teats with plenty of hair. You will see in the offering.





- Ranks in the top 3% for calving ease, 4% for birth weight and milk
- Her daughter, TRI-N Barbra Anne 83H, sells as lot 67
- A son, TRI-N Custer 1012G was selected by Beery Ranch, Richey, Montana
- Bred to SCX Jehu 233E on April 17, 2021
- Due January 27, 2022
- Exposed to SCX Jehu 233E from April 10 to August 2, 2021
- Pregnancy examined to the observed date

66

Lot 66 TRI-N BARBRA ANNE 1C

PFC418420 - NMF 1C - JANUARY 28 2015 - POLLED

HVA UPSTATE 8U
MVY XPLOER 21X
 BAR EW TANYA 13T

WHITECAP JUSTICE 67R
 HVA PANSY 8P
 LAE PARAGON 404P
 BAR E W HW 86H

LM MR IMP 382N
BREMNER'S BARB 67U
 BREMNER'S SPUNK 739P

JWK IMPRESSIVE D040 ET
 LM MS AMERICA ROYALE7139G
 SCM MONTANA MARBLER G216
 BREMNER'S MISS MONTE 632M

CE	BW	WW	YW	MILK	MTL
13.3	-3.7	26	45	28	41

Lot 66a TRI-N BARBRA ANNE 4J

PFC816891 - NMF 4J - FEBRUARY 06 2021 - POLLED

SCR TRIUMPH 2135
SCX JEHU 233E
 SCX MISS MAGNUM 109X

SCR TUFFY 0119
 SCR MS BABY DOLL 7140
 SCX HILARIO 49T
 SCX MISS CHICO 48P

MVY XPLOER 21X
TRI-N BARBRA ANNE 1C
 BREMNER'S BARB 67U

HVA UPSTATE 8U
 BAR EW TANYA 13T
 LM MR IMP 382N
 BREMNER'S SPUNK 739P

ACT BW	ADJ WW	CE	BW	WW	YW	MILK	MTL
92 lbs	704 lbs	10.2	-1.1	34	60	28	45



- Ranks in the top 25% milk, 20% calving ease and the top 15% for birth weight

66a



68a

Lot 67 TRI-N BARBRA ANNE 83H

PFC798104 - NMF 83H - MARCH 11 2020 - POLLED

SCR TRIUMPH 2135
SCX JEHU 233E
 SCX MISS MAGNUM 109X

MVY XPLOER 21X
TRI-N BARBRA ANNE 1C
 BREMNERS BARB 67U

SCR TUFFY 0119
 SCR MS BABY DOLL 7140
 SCX HILARIO 49T
 SCX MISS CHICO 48P

HVA UPSTATE 8U
 BAR EW TANYA 13T
 LM MR IMP 382N
 BREMNERS SPUNK 739P

CE	BW	WW	YW	MILK	MTL
9.2	-2.3	43	85	24	46

- Ranks in the top 10% for birth weight, 20% calving ease and the top 25% milk
- Her mother, TRI-N Barbra Anne 1C, sells as lot 66
- **A.I. bred to HVA Fireball 662F on May 5, 2021 – due February 15, 2022**
- **Exposed to K-Cow Gonzo 413G from May 26 to August 1, 2021**
- **Pregnancy examined favorable to the A.I. service**

Lot 68 TRI-N BARBRA ANNE 968G

QPFC771624 - NMF 968G - FEBRUARY 25 2019 - POLLED

LT LEDGER 0332 P
CFC ALREADY PLATINUM 167D
 CFC WYOMING WIND 42N

LT BLUEGRASS 4017 P
 LT BRENDA 6120 PLD
 LT WYOMING WIND 4020 PLD
 CFC PERFECTION 1K

PRO-CHAR CPTN. MORGAN 8U
 TRI-N BUFFY 79T
 LM MR IMP 382N
 BREMNERS SPUNK 739P

TRI-N CAPTAIN MORGAN 340A
TRI-N BARBRA ANNE 716E
 BREMNERS BARB 67U

CE	BW	WW	YW	MILK	MTL
11.0	-0.5	35	65	20	37

- Ranks in the top 10% for calving ease and 15% marbling
- **A.I. bred to SCX Jehu 233E on May 1, 2021 – due February 11, 2022**
- **Exposed to SCX Jehu 2 2236G from May 15 to August 2, 2021**
- **Pregnancy examined to the A.I. service**



68

Lot 68a TRI-N BARBRA ANNE 3J

NMF 3J - FEBRUARY 5 2021 - POLLED

SOS HOOEY PLD 127D
MCTAVISH ICON 20G
 MCTAVISH FAYE 93E

CFC ALREADY PLATINUM 167D
TRI-N BARBRA ANNE 968G
 TRI-N BARBRA ANNE 716E

WINN MANS CHAVEZ 826Y
 FFBB ABBI 307A
 WINN MANS CUERVO 4A
 MCTAVISH FAYE 37X

LT LEDGER 0332 P
 CFC WYOMING WIND 42N
 TRI-N CAPTAIN MORGAN 340A
 BREMNERS BARB 67U

ACT BW	ADJ WW	CE	BW	WW	YW	MILK	MTL
85 lbs	716 lbs	8.7	0.3	37	73	17	36

THE *Barbara Anne* INFLUENCE



The **MISS MELANIE** Family

An extremely productive cow family that's outcross to most genetics with lots of French influence in the back of the pedigree. This cow family includes TRI-N Miss Charhead 917W which is one of the most picturesque females you will find on the ranch. She is the dam of our mainstay TRI-N Red Baron 765E whose sons have been topping our bull sales the past few years. Excellent udders, heaps of hair. Premium cow family.



Working at HB Cattle (Utah)



Working at TRI-N

- Ranks in the top 20% of the breed for weaning weight and 25% for marbling
- Her mother, TRI-N Miss Charhead 917W, is the dam of TRI-N Red Baron 765E, herd bull for TRI-N.
- Bred to SCX Jehu 233E on April 18, 2021
- Due January 28, 2022
- Exposed to SCX Jehu 233E from April 10 to August 2, 2021
- Pregnancy examined to the observed date



69

Lot 69 TRI-N MISS MELANIE 852F

PFC750501 - NMF 852F - MARCH 21 2018 - POLLED

MERIT ROUNDUP 9508W
TRI-N ROCKEFELLER PLD 607D
 TRI-N NICKHEATA 950W

MXS VERMILLION 527R
 MERIT YOLANDA 7244T
 SOS CRIMSON TIDE 97S
 TRI-N NICKHEATA 98T
 BUTTE LEE DESIGNER 62D
 VAL-END XAVIER 50D
 CHARHEAD MR 39J
 CHARHEAD MISS 23JP

VAL-END APPRAISER 24J
TRI-N MISS CHARHEAD 917W
 CHARHEAD MISS 23R

CE	BW	WW	YW	MILK	MTL
6.2	1.0	51	93	10	36

Lot 69a TRI-N MISS MELANIE 63J

PFC816906 - NMF 63J - FEBRUARY 24 2021 - POLLED

SCR TRIUMPH 2135
SCX JEHU 233E
 SCX MISS MAGNUM 109X

SCR TUFFY 0119
 SCR MS BABY DOLL 7140
 SCX HILARIO 49T
 SCX MISS CHICO 48P

TRI-N ROCKEFELLER PLD 607D
TRI-N MISS MELANIE 852F
 TRI-N MISS CHARHEAD 917W

MERIT ROUNDUP 9508W
 TRI-N NICKHEATA 950W
 VAL-END APPRAISER 24J
 CHARHEAD MISS 23R

ACT BW	ADJ WW	CE	BW	WW	YW	MILK	MTL
90 lbs	869 lbs	5.6	0.2	57	111	15	44

- Ranks in the top 4% for yearling weight, the top 20% for carcass weight and the top 10% for weaning weight



69a



70

Lot 70 TRI-N MISS MELANIE 2405H

QPFC795147 - NYK 2405H - JANUARY 31 2020 - POLLED

TRI-N CAPTAIN MORGAN 340A
TRI-N RED BARON 765E
 TRI-N MISS CHARHEAD 917W

TRI-N CAPTAIN MORGAN 340A
TRI-N MISS MELANIE 8120F
 CHARHEAD MISS MEL 38Y

PRO-CHAR CPTN. MORGAN 8U
 TRI-N BUFFY 79T
 VAL-END APPRAISER 24J
 CHARHEAD MISS 23R

PRO-CHAR CPTN. MORGAN 8U
 TRI-N BUFFY 79T
 WRANGLER ON FIRE 49T
 MEL MS CHACONNE 14T

CE	BW	WW	YW	MILK	MTL
12.7	-4.8	48	83	17	41

- Ranks in the top 2% for birth weight and top 4% for calving ease
- Bred to Circle Cee Amplify 16H on April 18, 2021 – due January 28, 2022
- Exposed to Circle Cee Amplify 16H from May 9 to August 1, 2021
- Pregnancy examined favorable to the observed date

Lot 71 TRI-N MISS MELANIE 24H

QPFC798008 - NMF 24H - FEBRUARY 9 2020 - POLLED

SCR TRIUMPH 2135
SCX JEHU 233
 SCX MISS MAGNUM 109X

PRO-CHAR CPTN. MORGAN 8U
TRI-N MISS CHARHEAD 170Z
 TRI-N MISS CHARHEAD 917W

SCR TUFFY 0119
 SCR MS BABY DOLL 7140
 SCX HILARIO 49T
 SCX MISS CHICO 48P
 HARVIE REDEMPTION 36P
 EFH DAISY MAE 30J
 VAL-END APPRAISER 24J
 CHARHEAD MISS 23R

CE	BW	WW	YW	MILK	MTL
6.1	-0.2	46	94	21	44

- A.I. bred to HVA Fireball 662F on April 15, 2021 – due January 25, 2022
- Exposed to K-Cow Gonzo 413G from May 6 to August 1, 2021
- Pregnancy examined favorable to the A.I. service



71

The Tanzy's

This family started with the purchase of Cornerview Tanzy 28Z from the Uppin the Ante Sale in Ontario. Her dam was a past Toronto Royal Champion Female. She has proven to be a great addition including producing a son working well in a red Brahman herd in South Texas. Wait to see more as this is a newer cow family.



Lot **72**

TRI-N TANZY 832F

PFC750489 - NMF 832F - FEBRUARY 14 2018 - POLLED

SCC TIME BANDIT 290W
OC MR FREE TIME D279 ET
OCR MISS FASTBALL 16X

SPARROWS BARLOW 254Z
TRI-N TANZY 28D
CORNerview TANZY 28Z

SVY FREEDOM PLD 307N
PC MS CAVALRY P310 PLDET
LVB FASTBALL L325
OCR MISS PEUGEOT R41 TWK
LHJR BIG BANG
SPARROWS KYLIE 485U
SPARROWS COACH 467S
CORNerview TANSY 3T

BW	CE	BW	WW	YW	MILK	MTL
2.6	4.2	47	90	12	36	

- Ranks in the top 25% of the breed for carcass weight
- Her maternal sister, TRI-N Tanzy 934G, sells as lot 73
- A son, TRI-N South Dakota Boy 10H, was selected by Cunningham Cattle Company Inc., Sundre, Alberta
- **Bred to SCX Jehu 233E on April 16, 2021 – due January 26, 2022**
- **Exposed to SCX Jehu 233E from April 10 to August 2, 2021**
- **Pregnancy examined to the observed date**



Lot 72a TRI-N TANZY 73J
PFC816908 - NMF 73J - FEBRUARY 28 2021 - POLLED

SCR TRIUMPH 2135
SCX JEHU 233E
 SCX MISS MAGNUM 109X

OC MR FREE TIME D279 ET
TRI-N TANZY 832F
 TRI-N TANZY 28D

SCR TUFFY 0119
 SCR MS BABY DOLL 7140
 SCX HILARIO 49T
 SCX MISS CHICO 48P

SCC TIME BANDIT 290W
 OCR MISS FASTBALL 16X
 SPARROWS BARLOW 254Z
 CORNERVIEW TANZY 28Z

BW	ADJ WW	CE	BW	WW	YW	MILK	MTL
97 lbs	932 lbs	3.8	1.8	55	110	16	44

- Ranks in the top 5% for yearling weight, 10% for weaning and carcass weight and the top 25% for rib-eye



Lot 73 TRI-N TANZY 934G
PFC771695 - NMF 934G - FEBRUARY 16 2019 - POLLED

TRI-N THRILLER PLD 173Z
SCX THRILLER 89B
 BWK BURST MARBLER 1149

SPARROWS BARLOW 254Z
TRI-N TANZY 28D
 CORNERVIEW TANZY 28Z

TRI-N-SUPER JAMMER 7J
 TRI-N CREAMSICLE 85T
 FC MARBLER 864 P
 LJK MISS STARBURST 4006

LHJR BIG BANG
 SPARROWS KYLIE 485U
 SPARROWS COACH 467S
 CORNERVIEW TANSY 3T

CE	BW	WW	YW	MILK	MTL
2.2	3.6	49	101	22	47

- Ranks in the top 10% of the breed for carcass weight, the top 15% for yearling weight, and the top 20% for lean yield
 - Her maternal sister, TRI-N Tanzy 832F, sells as lot 72
 - Her mother TRI-N Tanzy 28D, is the dam of TRI-N Bon Jovi 16H selected by Leonard & Bonnie Zdan, Alonsa, Manitoba
 - Calved March 6, 2021 Heifer calf sired by McTavish Icon 20G BW: 87 lbs. Adj-205 day wt: 652 lbs.
 - Bred to SCX Jehu 2 236G on May 19, 2021 – due March 1, 2022
 - Exposed to SCX Jehu 2 236G from April 10 to August 2, 2021
 - Pregnancy examined to the observed date



Lot 74 TRI-N TANZY 931G
QPFC772937 - NMF 931G - FEBRUARY 16 2019 - POLLED

TRI-N CAPTAIN MORGAN 340A
TRI-N RED BARON 765E
 TRI-N MISS CHARHEAD 917W

SPARROWS COACH 467S
CORNERVIEW TANZY 28Z
 CORNERVIEW TANSY 3T

PRO-CHAR CPTN. MORGAN 8U
 TRI-N BUFFY 79T
 VAL-END APPRAISER 24J
 CHARHEAD MISS 23R

SPARROWS ALCATRAZ 18N
 SPARROWS VALIENTE 367P
 SVS NOBLEMAN 25N
 CORNERVIEW KERRI 4K

CE	BW	WW	YW	MILK	MTL
6.2	1.0	41	77	12	33

- Her mother, Cornerview Tanzy 28Z, is the dam of TRI-N East Bound and Down 739E, selected by Natchez Farms, Moody, Texas
 - Calved March 5, 2021 Heifer calf sired by McTavish Icon 20G BW: 104 lbs. Adj-205 day wt: 660 lbs.
 - Bred to Jack Foundation 7F on May 20, 2021 – due March 2, 2022
 - Exposed to Jack Foundation 7F from April 10 to August 2, 2021
 - Pregnancy examined to the observed date



76

Lot 75 SCF DAMARIS 326D

FFC706632 - SCF 326D - JANUARY 4 2016 - HORNED

IGLOO.MIC
 SIDNEY
 FONTAINE
 CASOAR
 SCF ZANNA 129Z
 PCFL CHEYANNE 9X

ABRICOT
 FRAICHE
 VIF
 CUIVREE
 NUPTIAL
 RITOURNELLE
 PCFL WILDFIRE 9T
 PCFL WYBOBBIE 117T

BW	CE	BW	WW	YW	MILK	MTL
	-4.1	3.2	54	95	16	43

- Ranks in the top 5% of the breed for rib-eye and fat, the top 10% for lean yield and the top 15% for weaning weight
- Her daughter, TRI-N French Maid 9423G, sells as lot 76
- Her son, TRI-N INXS 2429H, is herd bull for Ferme Louber ENR, Ste. Marie, Quebec
- Calved February 2, 2021 calf died at birth
- A.I. bred to SCX Jehu 233E on April 1, 2021 – due January 11, 2022
- Exposed to SCX Jehu 233E from April 1 to August 2, 2021
- Pregnancy examined to the A.I. date

The French Maids

We have selected a few full French females the past couple years in order to produce some outcross French genetics for our customers. Females were purchased from Stephen Charolais and Bar Punch Ranch. All have been excellent producers. These females are some of the meatiest females that I've seen and are excellent cows.

THE *French Maid* INFLUENCE

Lot 76 TRI-N FRENCH MAID 9423G

PFC771716 - NYK 9423G - FEBRUARY 23 2019 - POLLED

WINN MANS MARQUEZ 821U
 WINN MANS TERANTINO 9131Y
 WINN MANS SEDUCTIVE 9131W

SIDNEY
 SCF DAMARIS 326D
 SCF ZANNA 129Z

WINN MANS LANZA 610S
 WINN MANS LA SENZA 435P
 SPARROWS CAJUN 485N
 WINN MAN SEDUCTIVE 052K
 IGLOO.MIC
 FONTAINE
 CASOAR
 PCFL CHEYANNE 9X

BW	CE	BW	WW	YW	MILK	MTL
	-1.3	3.9	58	99	15	44

- Ranks in the top 5% of the breed for weaning weight, top 15% for rib-eye and lean yield, the top 20% for yearling weight and fat and the top 25% for carcass weight
- Her mother, SCF Damaris 326D, sells as lot 75
- Calved February 19, 2021 Bull Calf sired by McTavish Icon 20G BW: 87 ls. Adj-205 day wt: 768 lbs
- A.I. bred to SCX Jehu 233E on April 16, 2021 – due January 26, 2022
- Exposed to SCX Jehu 2 236G from May 1 to August 2, 2021
- Pregnancy examined to the A.I. date



75



Lot 77 TRI-N FRENCH MAID 9402G

PFC771607 - NYK 9402G - FEBRUARY 08 2019 - POLLED

TRI-N THRILLER PLD 173Z
SCX THRILLER 89B
 BWK BURST MARBLER 1149

VIZIR SC
BAR PUNCH MS VIZIR 4111B
 BAR PUNCH TANNIS 154Y

TRI-N-SUPER JAMMER 7J
 TRI-N CREAMSICLE 85T
 FC MARBLER 864 P
 LJK MISS STARBURST 4006

LE REBEL
 RENGAINE
 MAPLE LEAF BAR PUNCH8119U
 DWK TAMMY 3T

CE	BW	WW	YW	MILK	MTL
2.1	2.6	53	101	26	52

- Ranks in the top 4% of the breed for total maternal, 5% for rib-eye and lean yield, the top 10% for carcass weight and the top 15% for milk, weaning and yearling weight
- Her maternal sister, TRI-N French Maid 2443H sells as lot 78
- A maternal brother was selected by Kyle Sprung, Manitou, Manitoba
- **A.I. bred to SCX Jehu 233E on April 18, 2021 – due January 28, 2022**
- **Exposed to SCX Jehu 2 236G from May 2 to August 2, 2021**
- **Pregnancy examined to the A.I. date**



Lot 77a TRI-N FRENCH MAID 2127J

QPFC816878 - NYK 2127J - FEBRUARY 17 2021 - POLLED

HRJ BULLETPROOF 411B
B&L DARK HORSE 27G
 KLD24C

SCX THRILLER 89B
TRI-N FRENCH MAID 9402G
 BAR PUNCH MS VIZIR 4111B

SPARROWS KINGSTON 139Y
 HRJ MISS PARIS 7S
 LT LEDGER 0332 P
 KLD ROCKY ACRES 14Y

TRI-N THRILLER PLD 173Z
 BWK BURST MARBLER 1149
 VIZIR SC
 BAR PUNCH TANNIS 154Y

ACT BW	ADJ WW	CE	BW	WW	YW	MILK	MTL
96 lbs	876 lbs	4.3	1.8	46	91	20	43

Lot 78 TRI-N FRENCH MAID 2443H

PFC795351 - NYK 2443H - MARCH 15 2020 - POLLED

SCR TRIUMPH 2135
SCX JEHU 233E
 SCX MISS MAGNUM 109X

VIZIR SC
BAR PUNCH MS VIZIR 4111B
 BAR PUNCH TANNIS 154Y

SCR TUFFY 0119
 SCR MS BABY DOLL 7140
 SCX HILARIO 49T
 SCX MISS CHICO 48P

LE REBEL
 RENGAINE
 MAPLE LEAF BAR PUNCH8119U
 DWK TAMMY 3T

CE	BW	WW	YW	MILK	MTL
3.2	1.0	55	108	21	48

- Ranks in the top 5% of the breed for rib-eye, the top 10% for weaning weight, yearling weight and lean yield, the top 15% for carcass weight and the top 20% for total maternal
- Her maternal sister, TRI-N French Maid 9402G, sells as lot 77
- **A.I. bred to HVA Fireball 662F on April 15, 2021 – due January 25, 2022**
- **Exposed to K-Cow Gonzo 413G from May 6 to August 1, 2021**
- **Pregnancy examined favorable to the A.I. service**





80

Lot 79 TRI-N COSMO 9436G

PFC771717 - NMF 9436G - MARCH 4 2019 - POLLED

WINN MANS MARQUEZ 821U
WINN MANS TERANTINO 9131Y
 WINN MANS SEDUCTIVE 9131W

WINN MANS LANZA 610S
 WINN MANS LA SENZA 435P
 SPARROWS CAJUN 485N
 WINN MAN SEDUCTIVE 052K
 LAE WICHITA 911W
 TWN SABLE 33S
 BEAVER CREEK TORQUE 222T
 BEAVER CREEK COSMO 236N

TRI-N COSMO 125D
TRI-N COSMO 125D
 BEAVER CREEK XCELLIA 246X

BW	CE	BW	WW	YW	MILK	MTL
	4.3	1.8	59	98	15	44

- Ranks in the top 4% of the breed for weaning weight and the top 20% for yearling weight
- Her maternal sister, TRI-N Cosmo 2418H sells as lot 80
- Calved January 25, 2021 Heifer calf sired by McTavish 20G BW: 90 lbs. died on grass pneumonia
- **A.I. bred to SCX Jehu 233E on April 8, 2021 – due January 18, 2022**
- **Exposed to SCX Jehu 2 236G from April 22 to August 2, 2021**
- **Pregnancy examined to the A.I. date**

Lot 80 TRI-N COSMO 2418H

QPFC795167 - NMF 2418H - FEBRUARY 16 2020 - POLLED

HEJ CHESTER 1C
HEJ EINSTEIN 28E
 HEJ CATALINA SUNRISE 68C

HEJ ARMAGEDDON 84A
 HEJ MURPHY 61A
 ANCHOR J JIMMY 15Y
 HEJ TEQUILA SUNRISE 76Y

TWN YANGSTER 27Y
TRI-N COSMO 125D
 BEAVER CREEK XCELLIA 246X

LAE WICHITA 911W
 TWN SABLE 33S
 BEAVER CREEK TORQUE 222T
 BEAVER CREEK COSMO 236N

BW	CE	BW	WW	YW	MILK	MTL
	6.8	1.0	53	96	14	40

- Her maternal sister, TRI-N Cosmo 9436G, sells as lot 79
- **A.I. bred to HVA Fireball 662F on April 20, 2021 – due January 30, 2022**
- **Exposed to K-Cow Gonzo 413G from May 11 to August 1, 2021**
- **Pregnancy examined favorable to the A.I. service**



81

- Her mother, TRI-N Lady Time 128Y, is the dam of TRI-N Dressler and TRI-N Yangster, selected by Darin & Jackie Becker, Roblin, Manitoba
- Calved February 12, 2021 Heifer calf sired by McTavish Icon 20G BW: 97 lbs. Adj-205 day wt: 726 lbs.
- Bred to Jack Foundation 7F on May 18, 2021
- Due February 28, 2022
- Exposed to Jack Foundation 7F from April 10 to August 2, 2021
- Pregnancy examined to the observed date

Lot 81 TRI-N LADY TIME 9445G

QPFC772202 - NYK 9445G - FEBRUARY 28 2019 - POLLED

TRI-N CAPTAIN MORGAN 340A
TRI-N RED BARON 765E
 TRI-N MISS CHARHEAD 917W

PRO-CHAR CPTN. MORGAN 8U
 TRI-N BUFFY 79T
 VAL-END APPRAISER 24J
 CHARHEAD MISS 23R

TRI-N-PAYDAY 419P
TRI-N LADY TIME 128Y
 TRI-N LADY TIME 846U

SDC PROGRESS 16M
 TRI-N-GREAT ASTROID 49G
 SDC LAREDO 17N
 EABD LADY TIME 116L

CE	BW	WW	YW	MILK	MTL
10.7	-3.0	40	73	19	40

Lot 82 TRI-N LADY TIME 2420H

PFC795168 - NYK 2420H - FEBRUARY 18 2020 - POLLED

SCR TRIUMPH 2135
SCX JEHU 233E
 SCX MISS MAGNUM 109X

SCR TUFFY 0119
 SCR MS BABY DOLL 7140
 SCX HILARIO 49T
 SCX MISS CHICO 48P

TRI-N CAPTAIN MORGAN 340A
TRI-N LADY TIME 5142E
 TRI-N LADY TIME 128Y

PRO-CHAR CPTN. MORGAN 8U
 TRI-N BUFFY 79T
 TRI-N-PAYDAY 419P
 TRI-N LADY TIME 846U

CE	BW	WW	YW	MILK	MTL
4.4	1.2	66	124	18	51



82

- Ranks in the top 1% of the breed for weaning and yearling weight, the top 5% for carcass weight, the top 10% for total maternal, the top 20% for rib-eye, 15% lean yield
- A.I. bred to HVA Fireball 662F on April 10, 2021 - Due January 20, 2022
- Exposed to K-Cow Gonzo 413G from May 1 to August 1, 2021
- Pregnancy examined favorable to the A.I. service



Lot **83**

TRI-N ELIZA 92H

PFC798114 - NMF 92H - MARCH 16 2020 - POLLED

SCR TRIUMPH 2135
SCX JEHU 233E
 SCX MISS MAGNUM 109X

TMJF TOMSON 65T
TMJF WATERFALL 253W
 TMJF TAMARA 169T

SCR TUFFY 0119
 SCR MS BABY DOLL 7140
 SCX HILARIO 49T
 SCX MISS CHICO 48P
 BALDRIDGE FASTTRACK 82F
 TMJF PARIS 113P
 M6 GRID MAKER 104 PET
 TMJF RACHELLE 118R

CE	BW	WW	YW	MILK	MTL
9.3	-1.4	61	118	25	55

- Ranks in the top 1% of the breed for total maternal, the top 2% for yearling weight, the top 3% for weaning weight, the top 15% for carcass weight, the top 20% for calving ease, birth weight and milk and the top 25% for rib-eye and lean yield

- A.I. bred to HVA Fireball 662F on April 20, 2021 – due January 30, 2022
- Exposed to K-Cow Gonzo 413G from May 10 to August 1, 2021
- Pregnancy examined favorable to the A.I. service

“3 years ago, we began switching our bull pen to Charolais bulls for the simple fact the tan calves bring a premium in the ring. We have bought several bulls from Jesse and Merv over the past few years (all sight unseen) and found them to be sound, functional, and affordable. They cross very well on our angus-based cows by adding thickness and length yet maintaining calving ease. We have been very impressed with the vigour the calves have at birth, they are up and going immediately. Merv and Jesse know their cattle very well and highly recommend their bulls.”

Luke & Jenn Smith and family, Sundre, AB



- Ranks in the top 10% of the breed for rib-eye and marbling, the top 15% for lean yield and the top 25% for calving ease and fat
- Dam was the high selling heifer calf at Tee M Jay dispersal.
- A.I. bred to SCX Jehu 233E on April 12, 2021
- Due January 22, 2022
- Exposed to SCX Jehu 2 236G from April 26 to August 2, 2021
- Pregnancy examined to the A.I. date

Let 84 TRI-N EDREA 9432G

PFC772965 - NYK 9432G - MARCH 1 2019 - POLLED

LT LEDGER 0332 P	LT BLUEGRASS 4017 P
CFC ALREADY PLATINUM 167D	LT BRENDA 6120 PLD
CFC WYOMING WIND 42N	LT WYOMING WIND 4020 PLD
	CFC PERFECTION 1K
	MXS VERMILLION 527R
MERIT ROUNDUP 9508W	MERIT YOLANDA 7244T
TMJF EDREA 626E	SVY KABOOM PLD 7113T
TMJF ABIGAIL 392A	TMJF YOSSIE 300Y

CE	BW	WW	YW	MILK	MTL
8.5	1.6	41	79	19	40

Let 84a TRI-N EDREA 2101J

APPLIED FOR - NMF 2101J - JANUARY 29 2021 - POLLED

SOS HOOEY PLD 127D	WINN MANS CHAVEZ 826Y
MCTAVISH ICON 20G	FFBB ABBI 307A
MCTAVISH FAYE 93E	WINN MANS CUERVO 4A
	MCTAVISH FAYE 37X
	LT LEDGER 0332 P
CFC ALREADY PLATINUM 167D	CFC WYOMING WIND 42N
TRI-N EDREA 9432G	MERIT ROUNDUP 9508W
TMJF EDREA 626E	TMJF ABIGAIL 392A

ACT BW	ADJ WW	CE	BW	WW	YW	MILK	MTL
--	744 lbs	7.4	1.3	40	80	17	37



Lot 85 TRI-N CUTIE 801F

PFC750650 - NMF 801F - JANUARY 15 2018 - POLLED

EATONS BIG BUD 10402 P
PLEASANT DAWN CHISUM 216A
 PLESANT DAWN MAGGIE 316X

RAMM WHISTLER 8W
RAMM CUTIE 119C
 BAR J 127U

EATONS TREASURE 8076
 MISS GRAND HOUSE 360
 PLEASANT DAWN MAGNUM 56T
 PLEASANT DAWN RIO 216P

LT BLUEGRASS 4017 P
 RAMM TAMARA 50T
 BAR J RUPERT 200R
 BAR J SAVANA 12S

CE	BW	WW	YW	MILK	MTL
7.3	-2.0	36	79	23	41

- Ranks in the top 15% of the breed for birth weight
- Her daughter, TRI-N Cutie 14H, sells as lot 86
- **Bred to SCX Jehu 233E on April 18, 2021 - due January 28, 2022**
- **Exposed to SCX Jehu 233E from April 10 to August 2, 2021**
- **Pregnancy examined to the observed date**



85

Lot 85a TRI-N CUTIE 46J

PFC816943 - NMF 46J - FEBRUARY 20 2021 - POLLED

SCR TRIUMPH 2135
SCX JEHU 233E
 SCX MISS MAGNUM 109X

PLEASANT DAWN CHISUM 216A
TRI-N CUTIE 801F
 RAMM CUTIE 119C

SCR TUFFY 0119
 SCR MS BABY DOLL 7140
 SCX HILARIO 49T
 SCX MISS CHICO 48P

EATONS BIG BUD 10402 P
 PLESANT DAWN MAGGIE 316X
 RAMM WHISTLER 8W
 BAR J 127U

ACTBW	ADJWW	CE	BW	WW	YW	MILK	MTL
92 lbs	803 lbs	6.2	-1.3	50	104	21	46

- Ranks in the top 10% for yearling weight, the top 15% for marbling, top 20% for birth weight and the top 25% for weaning weight



85a

Lot 86 TRI-N CUTIE 14H

PFC795937 - NMF 14H - FEBRUARY 3 2020 - POLLED

LT RUSHMORE 8060 PLD
LT AFFINITY 6221 PLD
 LT ATHENA 1247

PLEASANT DAWN CHISUM 216A
TRI-N CUTIE 801F
 RAMM CUTIE 119C

LT RIO BRAVO 3181 P
 LT BRENDA'S EASE 3055PLD
 WINN MANS LANZA 610S
 LT SILVER ATHENA 7123 P

EATONS BIG BUD 10402 P
 PLESANT DAWN MAGGIE 316X
 RAMM WHISTLER 8W
 BAR J 127U

CE	BW	WW	YW	MILK	MTL
12.9	-4.3	38	79	22	42

- Ranks in the top 3% of the breed for birth weight, the top 4% for calving ease and the top 5% for marbling
- Her mother, TRI-N Cutie 801F, sells as lot 85
- **A.I. bred to HVA Fireball 662F on April 10, 2021 - due January 20, 2022**
- **Exposed to K-Cow Gonzo 413G from May 1 to August 1, 2021**
- **Pregnancy examined favorable to the A.I. service**



86



Lot **87** **TRI-N RAIN PLD 746E**

QPFC733420 - NMF 746E - FEBRUARY 21 2017 - POLLED

PRO-CHAR CPTN. MORGAN 8U
TRI-N CAPTAIN MORGAN 340A
 TRI-N BUFFY 79T

WINN MANS KANSAS 9135W
TRI-N RAIN PLD 432B
 FFBB JENNY PLD 295Z

HARVIE REDEMPTION 36P
 EFH DAISY MAE 30J
 TRI-N-PAYDAY 419P
 TRI-N BUFFY 6R
 WINN MANS LANZA 610S
 WINN MANS KIMBERLY 559R
 C2 SIR XTREME 34X
 FFBB RAIN PLD 835U

CE	BW	WW	YW	MILK	MTL
-2.0	5.2	50	108	14	39

- Ranks in the top 4% of the breed for carcass weight, the top 5% for marbling, the top 10% for yearling weight and fat, the top 15% for lean yield and the top 25% for weaning weight
- Her daughter, TRI-N Rain 927G, sells as lot 88
- **Bred to Jack Foundation 7F on May 10, 2021 – due February 20, 2022**
- **Exposed to Jack Foundation 7F from April 10 to August 2, 2021**
- **Pregnancy examined to the observed date**

- Ranks in the top 15% for fat and the top 25% for carcass weight



87a

Lot 87a TRI-N RAIN PLD 115J

QPFC818011 - NMF 115J - MARCH 16 2021 - POLLED

PRO-CHAR YELLOW JACKET 6C
JACK FOUNDATION 7F
 BREMNERS BRITTANY 348Y

HRJ WIDOW MAKER 12A
 PRO-CHAR SALLY 8Y
 TRI-N DIGGER DAN 938W
 BREMNERS SWEETIE 667M
 PRO-CHAR CPTN. MORGAN 8U
 TRI-N BUFFY 79T
 WINN MANS KANSAS 9135W
 FFBB JENNY PLD 295Z

TRI-N CAPTAIN MORGAN 340A
TRI-N RAIN PLD 746E
 TRI-N RAIN PLD 432B

ACTBW	ADJWW	CE	BW	WW	YW	MILK	MTL
89 lbs	893 lbs	0.3	4.4	45	91	18	41

Lot 88 TRI-N RAIN 927G

QPFC771619 - NMF 927G - FEBRUARY 13 2019 - POLLED

LT LEDGER 0332 P
CFC ALREADY PLATINUM 167D
 CFC WYOMING WIND 42N

LT BLUEGRASS 4017 P
 LT BRENDA 6120 PLD
 LT WYOMING WIND 4020 PLD
 CFC PERFECTION 1K

TRI-N CAPTAIN MORGAN 340A
TRI-N RAIN PLD 746E
 TRI-N RAIN PLD 432B

PRO-CHAR CPTN. MORGAN 8U
 TRI-N BUFFY 79T
 WINN MANS KANSAS 9135W
 FFBB JENNY PLD 295Z

CE	BW	WW	YW	MILK	MTL
2.4	5.6	38	81	17	36

- Ranks in the top 10% of the breed for rib-eye, fat, marbling and lean yield and the top 20% for carcass weight

- Her mother, TRI-N Rain 746E, sells as lot 87
- Calved March 8, 2021
- Heifer calf sired by McTavish Icon 20G BW: 102 lbs. Adj-205 day wt: 774 lbs.
- Bred to SCX Jehu 233E on April 12, 2021
- Due January 22, 2022
- Exposed to SCX Jehu 233E from April 10 to August 2, 2021
- Pregnancy examined to the observed date



88



Lot 89 **STEPPLER MISS 286B**

PFC406987 - DSY 286B - FEBRUARY 16 2014 - POLLED

ABC LATORO 263G
SPARROWS SEMINOLE 927W
 SPARROWS ANGEL EYES 258N

SPARROWS BERLIN 30M
STEPPLER MISS CELINE 1S
 STEPPLER MISS 5K

ABC EDMUND LATIN
 ABC CHAR CHISPA
 SPARROWS ALLIANCE 513G
 SPARROWS ANGEL EYES 58L
 SPARROWS ADVANTAGE 230H
 DOUBLE S GLAMOUR GIRL30G
 CS POLLED GILMOUR 3G
 STEPPLER MISS 74D

CE	BW	WW	YW	MILK	MTL
4.7	2.5	41	86	19	39

- She produced three herd bulls – TRI-N Bono 2414H selected by Horseshoe E Charolais, Kenaston, Saskatchewan and Legacy Charolais, Stettler, Alberta; TRI-N Prime Time 9405G selected by BINA Charolais, Lawton, North Dakota and TRI-N Impact 5123E selected by Luke Smith, Sundre, Alberta
- Bred to SCX Jehu 233E on April 6, 2021 – due February 5, 2022
- Exposed to SCX Jehu 233E from April 10 to August 2, 2021
- Pregnancy examined to the observed date



Lot 89A **TRI-N MISS CELINE 2129J**

PFC818097 - NYK 2129J - FEBRUARY 19 2021 - POLLED

SCR TRIUMPH 2135
SCX JEHU 233E
 SCX MISS MAGNUM 109X

SPARROWS SEMINOLE 927W
STEPPLER MISS 286B
 STEPPLER MISS CELINE 1S

SCR TUFFY 0119
 SCR MS BABY DOLL 7140
 SCX HILARIO 49T
 SCX MISS CHICO 48P
 ABC LATORO 263G
 SPARROWS ANGEL EYES 258N
 SPARROWS BERLIN 30M
 STEPPLER MISS 5K

BW	ADJWW	CE	BW	WW	YW	MILK	MTL
88 lbs	810 lbs	4.8	1.0	52	107	19	45

- Full sister to TRI-N Bono 2414H working at Horseshoe E and Legacy Charolais.
- Ranks in the top 10% for yearling weight, the top 15% for carcass weight and the top 20% for weaning weight



Lot 90 **TRI-N DAISY 627D**

PFC708895 - NMF 627D - FEBRUARY 19 2016 - POLLED

LAE WICHITA 911W
TWN YANGSTER 27Y
 TWN SABLE 33S

TRI-N PREFIX PLD ET 54Y
TRI-N DAISY 326A
 TRI-N DAISY 65Y

LT BLUEGRASS 4017 P
 LAE TANGO 707T
 ROCKLAND NOLAN 357N
 HOLMSYDE DREAM ALONG828H
 SILVERSTREAM PERFORMER38
 KCH MALIBU 1M
 BEAVER CREEK HARD-CORE299
 MEIER DAISY 753T

CE	BW	WW	YW	MILK	MTL
5.1	0.9	62	116	13	44

- Ranks in the top 2% of the breed for weaning weight and marbling, the top 3% for yearling weight and the top 20% for carcass weight
- She is the dam of TRI-N Van Halen 48H selected by Semex Alliance, Guelph, Ontario and TRI-N Rewind 1021G, selected by Riddell Farms, Pierson, Manitoba
- Calved March 27, 2021 Bull calf sired by HEJ Einstein BW: 92 lbs. Adj-205 day wt: 755 lbs. Feature in 2022 bull sale.
- Bred to SCX Jehu 233E on May 15, 2021 – due February 25, 2022
- Exposed to SCX Jehu 233E from April 1 to August 2, 2021
- Pregnancy examined to the observed date

- Ranks in the top 20% of the breed for marbling
- Maternal sister to high selling female in Ossim Livestock dispersal.
- Her daughter, TRI-N Foxy Fantasy 39H sells as lot 97
- Bred to Jack Foundation 7F on May 1, 2021
- Due February 11, 2022
- Exposed to Jack Foundation 7F from April 10 to August 2, 2021
- Pregnancy examined to the observed date



91

Lot 91 UNV FOXY FANTASY 123F

QPFC757622 - UNV 123F - FEBRUARY 15 2018 - POLLED

HBSF RED RIVER 61Z
ELDER'S CHROME 107C
 ELDER'S TEMPTRESS 11T

CRYSTAL D SIR BOOM 60S
CRYSTAL D WYNNE 110W
 CRYSTAL D RUZA 60R

HBSF EXPRESS 77X
 HIGHBLUFF MS ORIGINAL 4T
 ELDER'S COCOA 30P
 ELDER'S AURORA 11N
 MAUNGAHINA TOWKAY T13
 HARVIE MS MOLSON 53M
 RKG HOUSTON 108J
 CRYSTAL D MAYDA 21M

CE	BW	WW	YW	MILK	MTL
5.2	0.9	39	80	18	38

Lot 91a TRI-N FOXY FANTASY 48J

QPFC818066 - NMF 48J - FEBRUARY 21 2021 - POLLED

TR PZC MR TURTON 0794 ET
PCC GUALTIERI 858F
 PRAIRIE COVE MISS 309A

ELDER'S CHROME 107C
UNV FOXY FANTASY 123F
 CRYSTAL D WYNNE 110W

TR MR FIRE WATER 5792RET
 THOMAS MS IMPRESSIVE 0641
 HTA VEGAS 134Y
 PRAIRIE COVE MISS 911W
 HBSF RED RIVER 61Z
 ELDER'S TEMPTRESS 11T
 CRYSTAL D SIR BOOM 60S
 CRYSTAL D RUZA 60R

ACT BW	ADJ WW	CE	BW	WW	YW	MILK	MTL
93 lbs	725 lbs	6.0	1.3	41	79	23	43



91a



Lot 92 TRI-N MISS SYNERGY 9410G

PFC772959 - NYK 9410G - FEBRUARY 16 2019 - POLLED

LT LEDGER 0332 P
CFC ALREADY PLATINUM 167D
 CFC WYOMING WIND 42N

GRANT'S SYNERGY 41X
MISS LOUBER SYNERGY 859B
 MISS LOUBER VIRGIL 276Z

LT BLUEGRASS 4017 P
 LT BRENDA 6120 PLD
 LT WYOMING WIND 4020 PLD
 CFC PERFECTION 1K
 DBAR SYNERGY 721T
 DBAR CARISTA 425P
 VIRGIL SC
 LOUB MISS GRID 459TZ

CE	BW	WW	YW	MILK	MTL
8.2	1.3	34	63	21	38

- Ranks in the top 10% of the breed for rib-eye, the top 20% for lean yield and the top 25% for calving ease and fat
- A maternal brother, TRI-N Doc Holiday 2441H was selected by Lynn Cattle Co. Inc., Marquis, Saskatchewan
- Calved February 23, 2021 Heifer calf sired by McTavish Icon 20G BW: 86 lbs. Adj-205 day wt: 695 lbs.
- **A.I. bred to SCX Jehu 233E on April 8, 2021 – due January 18, 2022 - Exposed to SCX Jehu 2 236G from April 22 to August 2, 2021**
- Pregnancy examined to the A.I. date



Lot 93 TRI-N HARMONY 9442G

PFC778475 - NYK 9442G - MARCH 20 2019 - POLLED

WINN MANS SKAGGS 663X
SPARROWS LATIGO 436B
 SPARROWS BERNICE 18W

WINN MANS LANZADERO 849U
WOOD RIVER HARMONY 64A
 WOOD RIVER HARMONY 99N

MD ALI TRADE U1059
 WINN MANS BEVERLY 663S
 SPARROWS CERVEZA 106S
 STEPLER BERNIECE 18R
 WINN MANS LANZA 610S
 WINN MANS KIMBERLY 485P
 P-3 PERFECT LAD 0-17K
 WOOD RIVER CHARLENE 12J

CE	BW	WW	YW	MILK	MTL
-2.4	4.8	37	81	25	43

- Ranks in the top 15% of the breed for fat, the top 20% for milk and carcass weight
- Calved February 1, 2021 – calf died at birth - froze
- **A.I. bred to SCX Jehu 233E on April 26, 2021 – due February 6, 2022**
- **Exposed to SCX Jehu 2 236G from May 10 to August 2, 2021**
- Pregnancy examined to the A.I. date

Lot 94 TRI-N LADY RAVEN 9406G

PFC771710 - NYK 9406G - FEBRUARY 15 2019 - POLLED

WINN MANS MARQUEZ 821U
WINN MANS TERANTINO 9131Y
 WINN MANS SEDUCTIVE 9131W

SOS CRIMSON TIDE 97S
TRI-N LADY RAVEN 82Y
 JMK LADY RAVEN 7J

WINN MANS LANZA 610S
 WINN MANS LA SENZA 435P
 SPARROWS CAJUN 485N
 WINN MAN SEDUCTIVE 052K
 MGM MERLOT
 P-3 LADY PERFECT 6-146F
 NZL POLLED RAVEN 165Y
 TWINBIRCH LADY 54C

CE	BW	WW	YW	MILK	MTL
4.8	1.6	40	75	19	39

- A maternal sister to TRI-N Springstein 2483H working for Lynn Cattle Co. Inc., Marquis, Saskatchewan
- Calved March 17, 2021 heifer calf sired by McTavish Icon 20G BW: 80 lbs. Adj-205 day wt: 785 lbs.
- **Bred to SCX Jehu 2 236G on May 19, 2021 – due March 1, 2022**
- **Exposed to SCX Jehu 2 236G from April 10 to August 2, 2021**
- Pregnancy examined to the observed date



Lot 95 UNV LADY GLITTER 162G

PFC774059 - UNV 162G - FEBRUARY 20 2019 - POLLED

SKW EXPEDITION 89C
WRANGLER MAXIMUS 74E
 WRANGLER MS ROSE 14A

HEJ TRAPPER 53T
UNV LADY X 8X
 SDC TIFFINY 24R

LT SUNDANCE 2251 PLD
 SKW EDISON 77Z
 MERIT ROUNDUP 9508W
 LAE WESTERN ROSE 194Y
 HEJ MAGNUM 26R
 HEJ JONIE 45J
 HFCC PLD EVOLUTION 5L
 SDC BIONDA 32N

CE	BW	WW	YW	MILK	MTL
11.2	-3.2	46	79	19	42

- Calved February 15, 2021 Bull calf sired by McTavish Icon 20G BW: 85 lbs. Adj-205 day wt: 735 lbs.
- **Bred to SCX Jehu 2 236G on June 5, 2021 – due March 15, 2022**
- **Exposed to SCX Jehu 2 236G from April 10 to August 2, 2021**
- Pregnancy examined to the observed date

Lot **96**

TRI-N SASSY 27H

PFC798012 - NMF 27H - FEBRUARY 11 2020 - POLLED

SCR TRIUMPH 2135
SCX JEHU 233E
 SCX MISS MAGNUM 109X

TWN YANGSTER 27Y
TRI-N SASSY 584C
 TRI-N SASSY PLD 59S

SCR TUFFY 0119
 SCR MS BABY DOLL 7140
 SCX HILARIO 49T
 SCX MISS CHICO 48P

LAE WICHITA 911W
 TWN SABLE 33S
 TRI-N-PAYDAY 419P
 XPB MISS PERFECT 35J

CE	BW	WW	YW	MILK	MTL
6.9	-1.7	49	96	21	45

- Ranks in the top 15% of the breed for birth weight, the top 25% for yearling weight
- Maternal brother, TRI-N County Line 906F, was selected by Luke Smith, Sundre, Alberta
- A.I. bred to HVA Fireball 662F on April 19, 2021 – due January 29, 2022
- Exposed to K-Cow Gonzo 413G from May 10 to August 1, 2021
- Pregnancy examined favorable to the A.I. service

Lot **97**

TRI-N FOXY FANTASY 39H

QPFC810449 - NMF 39H - FEBRUARY 1 2020 - POLLED

KBK RALLY 24T
HTA TUFF ENUFF 947W
 HTA SARA 773T

ELDER'S CHROME 107C
UNV FOXY FANTASY 123F
 CRYSTAL D WYNNE 110W

JS EQUITY 11R
 KBK RED ROCK 14R
 HEJ RIPPER 66P
 HTA SARA 591R

HBSF RED RIVER 61Z
 ELDER'S TEMPTRESS 11T
 CRYSTAL D SIR BOOM 60S
 CRYSTAL D RUZA 60R

CE	BW	WW	YW	MILK	MTL
5.2	0.7	40	83	22	43

- Ranks in the top 20% for marbling
- Dam, UNV 123F sells as lot 91
- Bred to Circle Cee Amplify 16H on April 8, 2021 – due January 18, 2022
- Exposed to Circle Cee Amplify 16H from April 29 to August 1, 2021
- Pregnancy examined favorable to the observed date



Lot **98**

TRI-N JENNY 59H

QPFC798062 - NMF 59H - FEBRUARY 25 2020 - POLLED

HEJ CHESTER 1C
HEJ EINSTEIN 28E
 HEJ CATALINA SUNRISE 68C

BEAVER CREEK COUNTRY 261A
TRI-N JENNY 780E
 TRI-N JENNY 569C

HEJ ARMAGEDDON 84A
 HEJ MURPHY 61A
 ANCHOR J JIMMY 15Y
 HEJ TEQUILA SUNRISE 76Y

FFBB RED BUCKLE PLD 16X
 BEAVER CREEK GINGER 271W
 TWN YANGSTER 27Y
 FFBB JENNY PLD 295Z

CE	BW	WW	YW	MILK	MTL
3.1	2.6	52	102	15	41

- Ranks in the top 15% for yearling weight, the top 20% for weaning weight and carcass weight, and the top 25% for marbling
- Bred to Circle Cee Amplify 16H on June 1, 2021 – due March 1, 2022
- Exposed to Circle Cee Amplify 16H from April 20 to August 1, 2021
- Pregnancy examined favorable to the observed date

Lot **99**

TRI-N PRAIRIE STAR 63H

QPFC798066 - NMF 63H - FEBRUARY 27 2020 - POLLED

TRI-N CAPTAIN MORGAN 340A
TRI-N RED BARON 765E
 TRI-N MISS CHARHEAD 917W

TRI-N-PAYDAY 419P
TRI-N PRAIRIE STAR 126Y
 TRI-N PRAIRIE STAR 827U

PRO-CHAR CPTN. MORGAN 8U
 TRI-N BUFFY 79T
 VAL-END APPRAISER 24J
 CHARHEAD MISS 23R

SDC PROGRESS 16M
 TRI-N-GREAT ASTROID 49G
 SOS CRIMSON TIDE 97S
 TRI-N PRAIRIE STAR 56S

CE	BW	WW	YW	MILK	MTL
10.7	-2.7	40	70	22	41

- Ranks in the top 10% for birth weight, the top 15% for calving ease
- Maternal sister to TRI-N Strevler 971G, the \$45,000 high seller to Cliff Lee Enterprises (MO). Semen sold to Canada, USA and Australia.
- Bred to Circle Cee Amplify 16H on May 1, 2021 – due February 11, 2022
- Exposed to Circle Cee Amplify 16H from April 20 to August 1, 2021
- Pregnancy examined favorable to the observed date



100

- Ranks in the top 5% of the breed for calving ease, the top 10% for birth weight and the top 25% for marbling
- Bred to K-Cow Gonzo 413G on June 1, 2021
- Due March 11, 2022
- Exposed to K-Cow Gonzo 413G from April 20 to August 1, 2021
- Pregnancy examined favorable to the observed date

Lot 100 TRI-N VICTORIA 2401H

PFC795142 - NMF 2401H - JANUARY 21 2020 - POLLED

LT RUSHMORE 8060 PLD
 LT AFFINITY 6221 PLD
 LT ATHENA 1247

LT RIO BRAVO 3181 P
 LT BRENDA'S EASE 3055PLD
 WINN MANS LANZA 610S
 LT SILVER ATHENA 7123 P

GRANT'S PLAYBOY 3X
 ACC FANCY 902W
 SOS HEMI PLD 65N
 SOS BACHOLERETTE 41N

VIKSE PLAYBOY 67B
 VIKSE VICTORIA 73F
 SOS VICTORIA 32T

CE	BW	WW	YW	MILK	MTL
12.5	-3.1	33	66	21	38

Lot 101 TRI-N ROXANNA 2421H

PFC795337 - NYK 2421H - FEBRUARY 18 2020 - POLLED

SCR TRIUMPH 2135
 SCR MS BABY DOLL 7140
 SCX JEHU 233E
 SCX MISS MAGNUM 109X

SCR TUFFY 0119
 SCR HILARIO 49T
 SCX MISS CHICO 48P

NCC TRUE 97B
 TMJF EARTHA 663E
 TMJF WYNONA 254W

RC TRUE 791 PLD
 LM MS MESA 7184T
 HTA HOTSYS 550R
 HC LISA 109L

CE	BW	WW	YW	MILK	MTL
6.1	-0.7	56	113	21	49



101

- Ranks in the top 4% of the breed for yearling weight, the top 10% for weaning weight and carcass weight, the top 15% for total maternal and the top 25% for birth weight, rib-eye and lean yield
- A.I. bred to HVA Fireball 662F on April 9, 2021
- Due January 19, 2022
- Exposed to K-Cow Gonzo 413G from April 30 to August 1, 2021
- Pregnancy examined favorable to the A.I. service



Lot **102** **TRI-N CARLA 2448H**

PFC795355 - NYK 2448H - MARCH 19 2020 - POLLED

SCR TRIUMPH 2135
SCX JEHU 233E
 SCX MISS MAGNUM 109X

 MVX COUGARHILL HANK 720G
HAPPY HAVEN CALA 20C
 HAPPY HAVEN ROLO 64W

SCR TUFFY 0119
 SCR MS BABY DOLL 7140
 SCX HILARIO 49T
 SCX MISS CHICO 48P
 RAINBOW MR CYRANO 32D
 MVX EDITH 806X
 SOUTHERN PRAIRIE MR 71P
 HAPPY HAVEN ROLO 111

CE	BW	WW	YW	MILK	MTL
3.9	0.9	54	103	25	52

- Ranks in the top 5% of the breed for total maternal, the top 15% for weaning, yearling and carcass weight and the top 20% for milk, rib-eye and lean yield
- Her mother produced TRI-N Blizzard 9450G herd bull for Mark Frost, Kingsey-Falls, Quebec; TRI-N Cochise 8157F at Bar B Charolais, Cecil Lake, British Columbia and TRI-N Columbus 5103E at Cross Country Charolais, Fisher Branch, Manitoba
- **A.I. bred to HVA Fireball 662F on April 15, 2021 – due January 25, 2022**
- **Exposed to K-Cow Gonzo 413G from May 6 to August 1, 2021**
- **Pregnancy examined favorable to the A.I. service**



Lot **103** **PCC GUALTIERI 858F**

PEMC772928 - PCC 858F - SEPTEMBER 10 2018 - POLLED MALE

TR MR FIRE WATER 5792RET
TR PZC MR TURTON 0794 ET
 THOMAS MS IMPRESSIVE 0641

HTA VEGAS 134Y
PRAIRIE COVE MISS 309A
 PRAIRIE COVE MISS 911W

THOMAS OAHE WIND 0772ET P
 THOMASSWISSERSWEET1764ET
 JWK IMPRESSIVE D040 ET
 BCI MISS VERYLIMIT 6033P
 HTA SENATOR 8130U
 HTA PAGE (R) 694S
 JSR TROPHY 88T
 SPARROWS KRYSTAL 116R

CE	BW	WW	YW	MILK	MTL
6.8	1.6	43	77	27	48

- Ranks in the top 10% of the breed for milk
- Feature bull in 2020 Prairie Cove bull sale.
- Out of one of the most prolific donor cows in the breed. Progeny have topped sales for years and sold to many top breeders in North America
- Full brother to Cays Full House working at Stepler Farms, Miami Manitoba
- Many exciting sons sell at TRI-N Annual Bull Sale- March 22.
- Sells along with 2 daughters



Lot Ref A TRI-N RED BARON 765E

QPMC733434 - NMF 765E - FEBRUARY 28 2017 - HOMO POLLED

PRO-CHAR CPTN. MORGAN 8U
TRI-N CAPTAIN MORGAN 340A
 TRI-N BUFFY 79T

VAL-END APPRAISER 24J
TRI-N MISS CHARHEAD 917W
 CHARHEAD MISS 23R

HARVIE REDEMPTION 36P
 EFH DAISY MAE 30J
 TRI-N-PAYDAY 419P
 TRI-N BUFFY 6R
 BUTTE LEE DESIGNER 62D
 VAL-END XAVIER 50D
 CHARHEAD MR 39J
 CHARHEAD MISS 23J

CE	BW	WW	YW	MILK	MTL
13.4	-5.4	47	80	13	36

- Ranks in the top 1% of the breed for birth weight, the top 3 % for calving ease and the top 25% for marbling
 - 18 daughters sell



Lot Ref B SCX JEHU 2 236G

QPMC733434 - NMF 765E - FEBRUARY 28 2017 - HOMO POLLED

SCR TRIUMPH 2135
SCX JEHU 233E
 TSCX MISS MAGNUM 109X

HARVIE TRIGGER 15Y
SCX MISS TRIGGER 117C
 SCX MISS12Z

SCR TUFFY 0119
 SCR MS BABY DOLL 7140
 SCX HILARIO 49T
 SCX MISS CHICO 48P
 HARVIE CRYSTAL D TRIGGER 35T
 HARVIE MS POLLY 50W
 SCX DIAMOND 1X
 SCX MISS DIAMOND 17W

CE	BW	WW	YW	MILK	MTL
5.4	-0.2	49	106	26	51

- Ranks in the top 10% of the breed for yearling weight, milk, total maternal and marbling and the top 15% for carcass weight
 - His service sells



Lot Ref C HVA FIREBALL 662F

PMC748490 - HVA 662F - JANUARY 10 2018 - HOMO POLLED

PLEASANT DAWN MVP 316Y
TURNBULLS DUTY-FREE 358D
 CTP MISS GOOGLE 358Z

RGP REMINGTON 101Y
HTA SARA 662D
 HTA SARA 9107W

PLEASANT DAWN MAGNUM 56T
 PLEASANT DAWN RIO 216P
 PLEASANT DAWN MAXIMUM138X
 RTP MISS SELECT 14K
 MERIT 8789U
 RGP LUCILLE 101L
 SVS NOBLEMAN 25N
 HTA SARA 903J

CE	BW	WW	YW	MILK	MTL
6.1	1.6	53	109	23	49

- Ranks in the top 5% of the breed for carcass weight, the top 10% for yearling weight and marbling, the top 15% for weaning weight and total maternal and the top 25% for lean yield
 - A.I. service sire on the bred heifers



Lot Ref D CIRCLE CEE AMPLIFY 16H

QPMC794586 - CEE 16H - FEBRUARY 29 2020 - POLLED

HRJ MAVERICK 556C
LAE EASTON 702E
 LAE CALYPSO 555C

TRI-N JOHNNY ROCKET 925W
CIRCLE CEE RIO CARNIVAL 144Y
 CEE RIO BLANCA 704T

WC DOUBLETREE 2009 P
 PRO-CHAR CASSY 32A
 CIRCLE CEE LEGEND 307A
 LAE ANGEL EYES 310A
 TRI-N-PAYDAY 419P
 TRI-N-FREINDLY 403P
 LT RIO BLANCO 1234 P
 HFCC WHITE PROMISE 34L

CE	BW	WW	YW	MILK	MTL
9.0	-1.8	50	85	25	50

- Ranks in the top 10% of the breed for total maternal, the top 15% for birth weight, the top 20% for calving ease and milk and the top 25% for weaning weight
 - His service sells



Ref E K-COW GONZO 413G

PMC778364 - KJW 413G - SEPTEMBER 20 2019 - POLLED

MVY XPLOER 21X
K-COW HARLEM 3E
 JIL FRENCH KISS 3BT

HVA UPSTATE 8U
 BAR EW TANYA 13T
 DUBUC ZENITH 20Z
 JIL SHEZA DIAMOND 8Z

XAL FIRESTRUCK 3Z
CIRCLE CEE SECRET 413B
 CEE'S GOSSIP GAL 205Z

TR MR FIRE WATER 5792RET
 MEDONTE WONDER STRUCK 12W
 HBC DURAMAX 711T
 MEDONTE RUMOURS 9R

CE	BW	WW	YW	MILK	MTL
10.0	-2.2	37	68	28	46

- Ranks in the top 10% of the breed for milk and the top 15% for calving ease and birth weight
- His service sells

Ref G MCTAVISH ICON 20G

PMC773442 - BBMT 20G - JANUARY 06 2019 - HOMO POLLED

WINN MANS CHAVEZ 826Y
SOS HOOEY PLD 127D
 FFBB ABBI 307A

WINN MANS CUERVO 4A
MCTAVISH FAYE 93E
 MCTAVISH FAYE 37X

MERIT 7329T
 WINN MANS BREATHLESS 826U
 CSS SIR NAVIGATOR 20Y
 FFBB MISS SILVA PLD 730T

SPARROWS BIRMINGHAM 758T
 WINN MANS VANESSA 9104W
 GILLILAND DIAGO 7R
 MCTAVISH MS FAYETTE 52P

CE	BW	WW	YW	MILK	MTL
6.4	1.0	39	81	13	32

- Ranks in the top 15% of the breed for marbling
- 6 daughters



Ref F JACK FOUNDATION 7F

QPMC764599 - JACK 7F - FEBRUARY 15 2018 - HOMO POLLED

HRJ WIDOW MAKER 12A
PRO-CHAR YELLOW JACKET 6C
 PRO-CHAR SALLY 8Y

SPARROWS KINGSTON 139Y
 HRJ MISS PARIS 7U
 PRO-CHAR CPTN. MORGAN 8U
 SOS MUSTANG SALLY 143R

TRI-N-DIGGER DAN 938W
BREMNERS BRITTANY 348Y
 BREMNERS SWEETIE 667M

TRI-N-PAYDAY 419P
 TRI-N-RATIONELLE 26R
 VAL-END APPRAISER 24J
 JACK LITTLE FREDA 330G

CE	BW	WW	YW	MILK	MTL
3.0	3.2	40	70	20	40

- Ranks in the top 15% of the breed for fat
- 4 daughters sell
- Services sell

Ref H B&L DARK HORSE 27G

QPMC778704 - BLE 27G - JANUARY 22 2019 - HOMO POLLED

SPARROWS KINGSTON 139Y
HRJ BULLETPROOF 411B
 HRJ MISS PARIS 7S

WINN MANS LANZA 610S
 SPARROWS DELIGHT 374P
 HRJ MR RED TAZ 23P
 HRJ MISS PARIS 40P

LT LEDGER 0332 P
KLD24C
 KLD ROCKY ACRES 14Y

LT BLUEGRASS 4017 P
 LT BRENDA 6120 PLD
 SVS NOBLEMAN 25N
 KLD ROCKY ACRES 28R

CE	BW	WW	YW	MILK	MTL
8.0	-0.8	43	85	22	43

- Ranks in the top 20% of the breed for rib-eye and the top 25% for birth weight
- 2 daughters sell
- Services sell





Lot Ref I CFC ALREADY PLATINUM 167D

PMC708721 - CFC 167D - MARCH 31 2016 - POLLED

LT BLUEGRASS 4017 P
LT LEDGER 0332 P
 LT BRENDA 6120 PLD

LT WYOMING WIND 4020 PLD
CFC WYOMING WIND 42N
 CFC PERFECTION 1K

LT ASSERTION 1277P
 LT PEARL'S BREEZE 2236 P
 LT RIO BRAVO 3181 P
 LT BRENDA'S EASE 3055PLD
 SCHURRTOP 5627
 TLT CHAP'S LADY 2170P
 LHD MR PERFECT Y416
 CFC SHEZA OVATION 44E

CE	BW	WW	YW	MILK	MTL
14.7	-2.0	22	41	22	33

- Ranks in the top 2% of the breed for calving ease, the top 10% for rib-eye and marbling and the top 15% for birth weight
 - 9 daughters sell

Lot Ref J WINN MANS TERANTINO 9131Y

PMC347346 - BKJ 9131Y - APRIL 2 2011 - HOMO POLLED

WINN MANS LANZA 610S
WINN MANS MARQUEZ 821U
 WINN MANS LA SENZA 435P

SPARROWS CAJUN 485N
WINN MANS SEDUCTIVE 9131W
 WINN MAN SEDUCTIVE 052K

SPARROWS DURANGO 585P
 WINN MAN MERIT 036K
 BKJ BUCKAROO 836H
 BKJ CORONA PLD 719G
 ABC LATORO 263G
 BECK'S KYLIE 485K
 RMR COHIBA
 BKJ SEDUCTIVE 837H

CE	BW	WW	YW	MILK	MTL
4.5	1.7	59	96	15	45

- Ranks in the top 4% of the breed for weaning weight and the top 25% for yearling weight
 - 11 daughters sell



Lot Ref K HEJ EINSTEIN 28E

QPMC721976 - HEJ 28E - JANUARY 06 2017 - HOMO POLLED

HEJ ARMAGEDDON 84A
HEJ CHESTER 1C
 HEJ MURPHY 61A

ANCHOR J JIMMY 15Y
HEJ CATALINA SUNRISE 68C
 HEJ TEQUILA SUNRISE 76Y

MERIT ROUNDUP 9508W
 HEJ RED RIDING HOOD 40R
 MERIT ROUNDUP 9508W
 HEJ VIVEKA 73X
 NCLP TRIPLE THREAT 914W
 ANCHOR J 67P
 SPARROWS FARGO 811U
 HEJ QUEDIRA 80P

CE	BW	WW	YW	MILK	MTL
9.2	-0.4	45	90	13	36

- Ranks in the top 20% of the breed for calving ease
 - 7 daughters sell

Lot Ref L SCX THRILLER 89B

SMC367206 - SCX 89B - APRIL 1 2014 - SCURS

TRI-N-SUPER JAMMER 7J
TRI-N THRILLER PLD 173Z
 TRI-N CREAMSICLE 85T

FC MARBLER 864 P
BWK BURST MARBLER 1149
 LJK MISS STARBURST 4006

4-L UNLIMITED YL13POLLED
 TRI-N-XLASSY POLLED 5X
 TRI-N-PAYDAY 419P
 TRI-N-CREAMSICLE 2R
 SCM MARBLER P506
 FUNKS MS MONTANA 724 P
 KEYS STARBURST 350L
 JJK MISS UNLIMITED 0053

CE	BW	WW	YW	MILK	MTL
3.9	2.0	65	121	29	61

-Ranks in the top 1% for weaning weight, yearling weight, carcass weight and total maternal, the top 3% for milk, top 5% for lean meat yield and top 10% for rib-eye.
 - 6 daughters sell



Cow Family Index

Malibu	2-3
Prairie Rose	4-21
Creamsicle	22-29
Buffy	30-32
Monte Python	33-35
Reba	36-41
Marlene	42-52
Rationelle	53-56
Sally	57-59
Nickheata	60-65
Barbra Anne	66-68
Miss Melanie	69-71
Tanzy	72-74
French Maid	75-78
Other Families	79-88
Prooven Brood Matrons	89-91
Exciting First Calvers	92-95
Futuristic Bred Heifers	96-102

Tattoo Index

SCX 233E	1	NMF 988G	34	NMF 852F	69
NMF 72B	2	NMF 6J	34A	NMF 63J	69A
NYK 2105J	2A	NMF 8H	35	NYK 2405H	70
NYK 2416H	3	NMF 561C	36	NMF 24H	71
NMF 37H	4A	NMF 41J	36A	NMF 832F	72
NMF 74H	4B	NMF 601D	37	NMF 73J	72A
NMF 76H	4C	NMF 2435H	38	NMF 934G	73
NMF 2425H	4D	NMF 4H	39	NMF 931G	74
NMF 43H	5	NMF 998G	40	SCF 326D	75
NMF 1008G	6	NMF 962G	41	NYK 9423G	76
NMF 725E	7	NMF 604D	42	NYK 9402G	77
NMF 916G	8	NMF 941G	43	NYK 2127J	77A
NMF 35H	9	NMF 19H	44	NYK 2443H	78
NMF 36H	10	NMF 930G	45	NMF 9436G	79
NMF 581C	11	NMF 60J	45A	NMF 2418H	80
NMF 39J	11A	NMF 91H	46	NYK 9445G	81
NMF 1019G	12	NMF 52H	47	NYK 2420H	82
NMF 55H	13	NMF 530C	48	NMF 92H	83
NMF 73H	14	NMF 122J	48A	NYK 9432G	84
NMF 109H	15	NMF 1014G	49	NYK 2101J	84A
NMF 824F	16	NMF 913G	50	NMF 801F	85
NMF 732E	17	NMF 403B	51	NMF 46J	85A
NMF 60H	18	NMF 1010G	52	NMF 14H	86
NMF 49H	19	NMF 9429G	53	NMF 746E	87
NMF 37G	20	NMF 928G	54	NMF 115J	87A
NMF 133J	20A	NMF 1009G	55	NMF 927G	88
NMF 1027G	21	NMF 1030G	56	DSY 286B	89
NMF 850F	22	NMF 21H	57	NYK 2129J	89A
NMF 67H	23	NMF 66H	58	NMF 627D	90
NMF 972G	24	NMF 41H	59	UNV 123F	91
NMF 64H	25	NMF 846F	60	NMF 48J	91A
NMF 989G	26	NMF 47J	60A	NYK 9410G	92
NMF 9448G	27	NMF 984G	61	NYK 9442G	93
NMF 2143J	27A	NMF 15H	62	NYK 9406G	94
NMF 68H	28	NMF 13H	63	UNV 162G	95
NMF 51H	29	NMF 956G	64	NMF 27H	96
NMF 180Z	30	NMF 958G	65	NMF 39H	97
NYK 2402H	30A	NMF 9J	65A	NMF 59H	98
NMF 1002G	31	NMF 1C	66	NMF 63H	99
NMF 46H	32	NMF 4J	66A	NMF 2401H	100
NMF 678D	33	NMF 83H	67	NYK 2421H	101
NMF 10J	33A	NMF 968G	68	NYK 2448H	102
		NMF 3J	68A	PCC 858F	103

TERMS AND CONDITIONS

Terms

The terms of the sale are cash or cheque, payable at par at the sale location. The right of property shall not pass until after settlement has been made; no invoicing on buyers in attendance unless previous arrangements have been made. Every animal sells to the highest bidder and in cases of disputes, the auctioneer's decision will be final. Announcements from the auction block will take precedence over the printed matter in the catalogue. Current exchange rates will be announced sale day. All monies are in Canadian funds.

Certificate of Registration

Each animal will carry papers issued by the Canadian Charolais Association. A certificate of registry duly transferred will be furnished to the buyer for each animal after payment has been made.

Pedigree Estimates

Pedigree Estimates (PE) are created on the projected mating of the animal's sire and dam based on averages of the two, creating estimated values that do not hold the same accuracy of actual EPDs issued from the association and should be used as such.

Health

All animals in the sale have met all necessary health requirements.

Guarantee

Each animal becomes the purchaser's risk immediately after the animal is sold. All animals in this sale will be sold under the terms and guarantees set forth by the Canadian Charolais Association with regards to health, freedom from defects and from both reproductive and specific genetic unsoundness.

Pregnancy Information

All serviceable age females have been pregnancy examined by an accredited veterinarian, giving an estimated length of gestation. This estimated gestation period shall be used only as a guideline to calving and is not a guarantee of actual service.

Liabilities

All persons attend the sale at their own risk. The seller, facility owner and sale manager assume no liability, legal or otherwise, for any accidents that occur. It is understood that T Bar C Cattle Co. (2013) Ltd. is acting only as a medium between buyer and seller and is not responsible for any failure on the part of either party to live up to his obligations. Neither does T Bar C Cattle Co. (2013) Ltd. assume any financial obligations to collect or enforce collection of any monies between parties and any legal action that may, in exceptional cases, be taken must be between the buyer and the seller. T Bar C Cattle Co. (2013) Ltd. assumes no responsibility for any credit extended by the seller to the buyer. The buyer must look to the seller for fulfillment of all guarantees and representations made hereunder.

Delivery

Assistance will be given in getting your purchases home. Each animal becomes the risk of the purchaser as soon as sold. We ask that all purchases are picked up or delivered by December 16, 2021 unless prior arrangements have been made.

Phone, Mail, Wire Bids

Bidders unable to attend the sale may phone, wire or mail their bids and instructions to the sale manager, auctioneer or special representatives. Bids must be received in sufficient time prior to the sale.

Insurance

We strongly recommend that insurance is purchased for full value.

Errors

All announcements at sale time, written or oral, supersede any written material in the catalogue.

Thanks to all our supporters far and wide the past 37 Years.

WATCH FOR BULLS LIKE THIS IN OUR 7TH ANNUAL
TRI-N CHAROLAIS BULL SALE - MARCH 21 - ON THE FARM - LENORE MB!!



2014 HIGH SELLER TO CLEVELAND CHAROLAIS, SD



2015 HIGH SELLER TO R+G MACDONALD LIVESTOCK, MB



2016 HIGH SELLER TO SPRUCE VIEW CHAROLAIS, AB



2017 HIGH SELLER TO CIRCLE 5 RANCH, ND



2018 HIGH SELLER TO BRASHER CHAROLAIS, UT & DENNIS CHAROLAIS, TX



2019 HIGH SELLER TO CLIFF LEE ENTERPRISES, MO



2020 HIGH SELLER TO CLIFF LEE ENTERPRISES, MO AND THE
STREVELER GROUP



2020 HIGH SELLER TO PALMER CHAROLAIS, SK AND BOB CHAROLAIS, AB

Return Undeliverable
Canadian Addresses To:

T Bar C Cattle Co. Ltd.
Box 2330
Warman, SK S0K 4S0



"See you down the trail!"



Created by

